

THIS DRAWING REFERS TO THE FOLLOWING PRODUCTS:-

LR15F  
LR30F  
MLS2500CDR  
MLS2500DALIF  
MLS2500DALIWLF  
MLS2500DF  
MLS2500DWLF  
MR1500PF  
MR2500DALIF  
MR2500DF

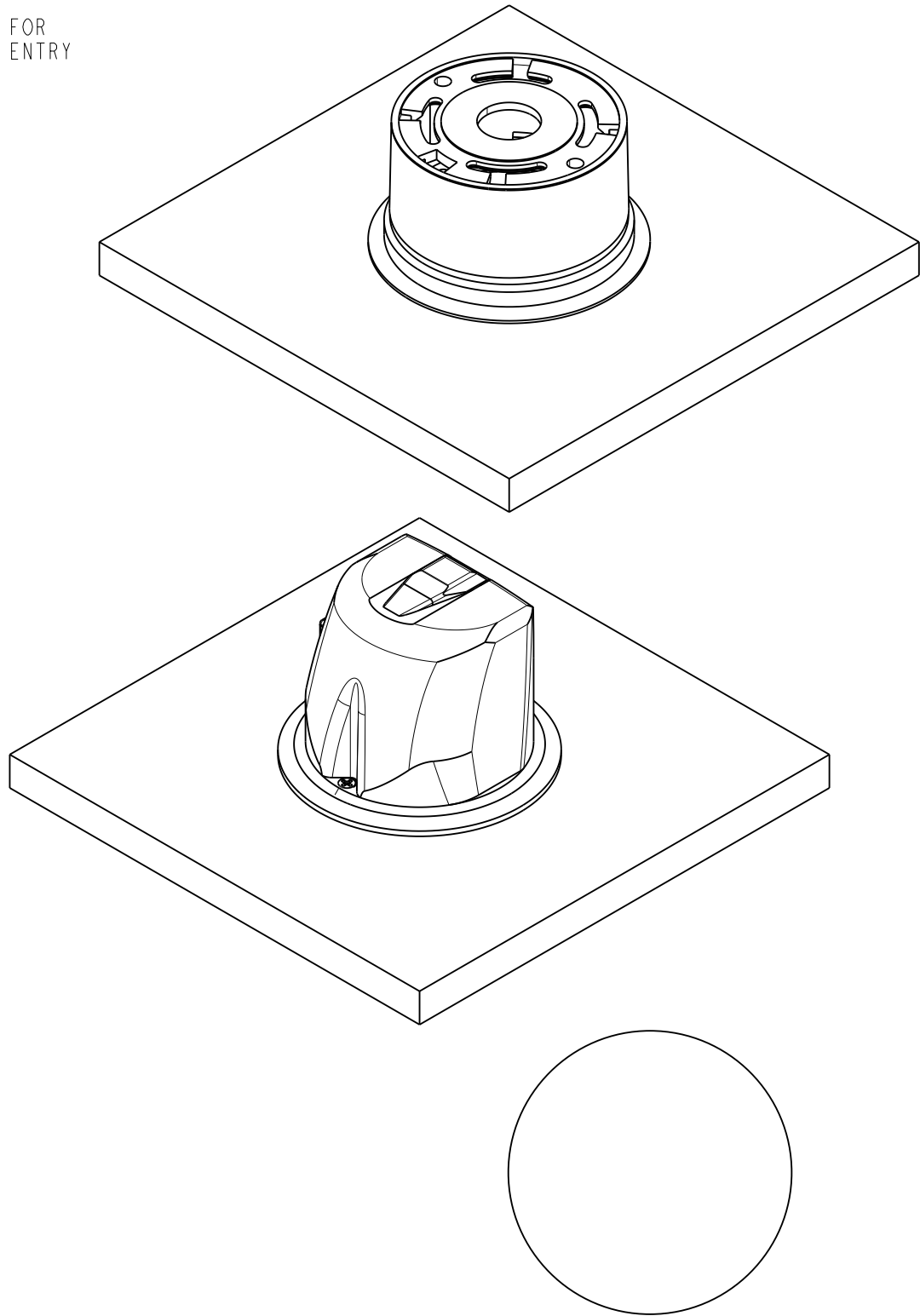
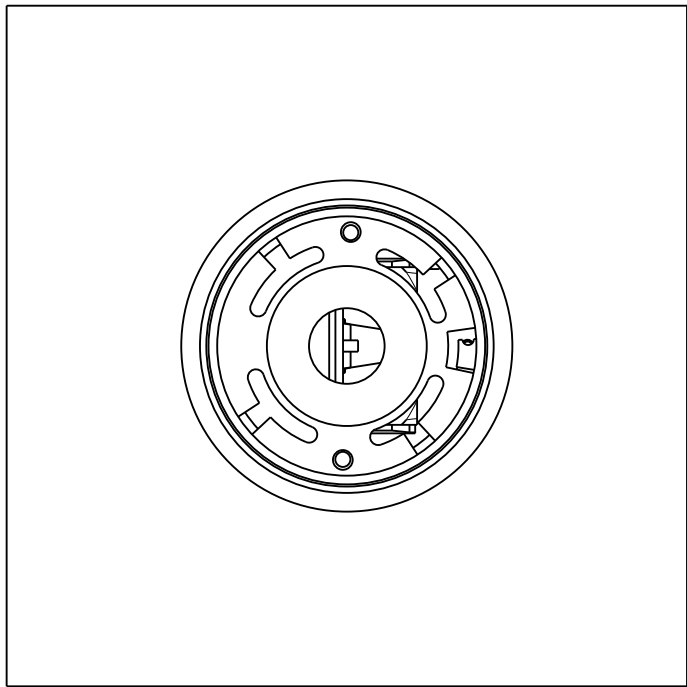
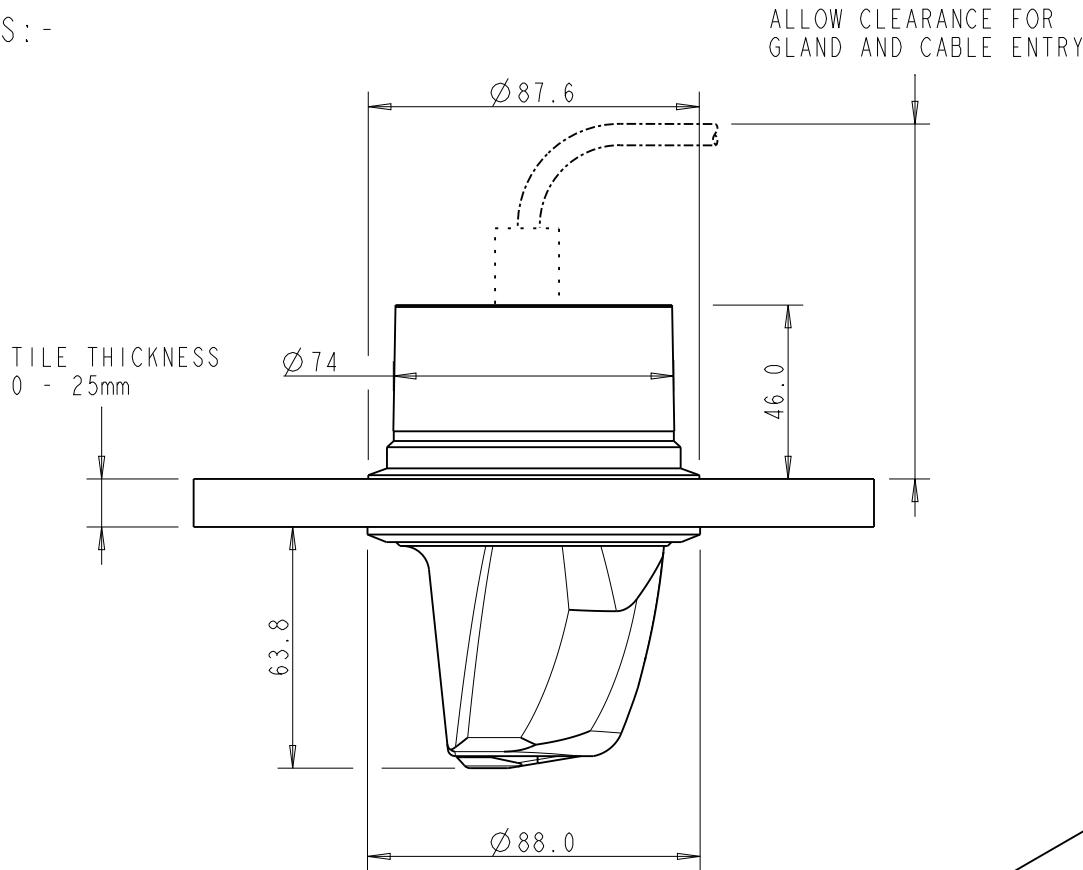

HOLE DIAMETER  $75.0 \pm \begin{smallmatrix} 3.0 \\ 0 \end{smallmatrix}$

MATERIALS:-

ALL MAIN HOUSING PARTS - UL94 V-2, 960° GLOW-WIRE  
RATED POLYCARBONATE, COLOUR - WHITE, RAL9010

MODIFICATION TEXT:



NOVAR ED&S  
ARLINGTON BUSINESS PARK  
BRACKNELL  
BERKS RG12 1EB

HONEYWELL CONFIDENTIAL AND PROPRIETARY

PROTECTED BY  
DIN ISO 16016

FIRST ANGLE PROJECTION

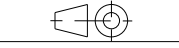

UNITS  
mm

GENERAL TOLERANCES:

LINEAR  $\pm 0.15$   
HOLE DIA  $\pm 0.08$   
RADII  $\pm 0.05$   
ANGULAR  $\pm 0.50$

DRAWN BY: Harrison, John Robert

DIMENSIONS AND TOLERANCES PER  
BRITISH STANDARDS AND  
ECC ENGINEERING STANDARDS

MATERIAL  
AS SHOWN

FINISH

PACKAGING SPEC. No:

PERMIT No:

IMPRESSIONS:

LIFECYCLE STATE: In Work

DRAWN BY DATE: 24-Mar-2015

**Honeywell**

ENVIRONMENTAL & COMBUSTION CONTROLS

TITLE

OUTLINE DRAWING

SUB TITLE

FLUSH CORNER-MOUNT MICROWAVE SENSORS

DRAWING No.

32308248

ECO No.

ECO DATE

REV

01

PROJ NO. 714147

PAPER SIZE A3

SCALE 1:2

SHEET 1 OF 1

THIS PRODUCT MUST BE PRODUCED USING ROHS COMPLIANT MATERIALS  
AND PROCESSES PER HONEYWELL SPECIFICATION ES50040083

PRO/E