

# MAXPRO® NVR SOFTWARE

## Network Video Recording Solution



MAXPRO NVR SERVER – VERSION 5.6 OR ABOVE UP TO 8 OR 16 CHANNELS	
<b>PROCESSOR</b>	Intel® Core™ i5-7500, 3.4 GHz or higher
<b>SYSTEM MEMORY (RAM)</b>	Minimum 8 GB or higher
<b>OS &amp; APPLICATION – HARD DISK DRIVE OR PARTITION</b>	Minimum 200 GB Partition drive or separate hard drive
<b>GRAPHICS ADAPTER</b>	Minimum In-built Processor Graphics (GPU):Intel® HD Graphics 630 or equivalent for local client GPU rendering support
<b>NETWORK INTERFACE</b>	Minimum – 2 Gigabit network interface card
<b>OPTICAL DRIVE</b>	Optional DVD-RW
<b>VIDEO STORAGE DRIVE</b>	Video rated or Enterprise drive, 7200 RPM SATA/SAS recommended
<b>MONITOR RESOLUTION</b>	Video resolution 1280x1024 pixels or higher, 32 bit
<b>KEYBOARD / MOUSE</b>	102-key keyboard and mouse
<b>OPERATING SYSTEM OPTIONS</b>	Microsoft® Windows 10, Windows 10 IoT Enterprise for Embedded Systems, Windows Server 2008 R2, 2012 R2 and 2016
<b>DATABASE</b>	Microsoft® SQL Server® 2012 Express is automatically installed while installing MAXPRO NVR Server
SUPPORTED PERFORMANCE – 64-BIT WINDOWS OS	
<b>RECORDING AND MONITORING PERFORMANCE</b>	16 channels with 480 fps @ 4CIF/VGA or 480 fps @ 720p HD or 480 fps @ 1080p (4 Mbps bitrate) HD. 1-way audio for up to 8 or 16 IP channels. Network bandwidth/throughput supported per NVR with Incoming: 65 Mbps, Outgoing:180 Mbps providing a Total: 245 Mbps. Rendering performance using GPU of up to 4 1080p HD @ 30 fps / 120 fps on local client. Note: Oncam Grandeye 360 cameras are not supported with GPU rendering and use CPU rendering by default.
<b>SERVER BASED VMD (SMART VMD) PERFORMANCE - CHANNELS SUPPORTED</b>	All 8 or 16 channels supported at 480 fps @ 4CIF/VGA or 480 fps @ 720p HD or 480 fps @ 1080p HD or total 32 Megapixel.
<b>MAX VIDEO STREAMS SUPPORT</b>	Web Client: Live - 64 streams, Playback - 32 streams. Note: Live streams consumed are per camera being viewed live and duplicate live views of the same camera in multiple or same web client instance are allowed without consuming additional streams. Playback streams consumed are per playback stream being viewed and each playback stream being viewed consumes 1 additional stream. Desktop Client: Live - 256 streams, Playback/Video retrieval sessions - 32, Sync playback - 9 streams 256 live streams limit excludes 1 stream used per camera if SMART VMD is enabled. Maximum live streams per camera is 15 with SMART VMD enabled. Mobile App: 16 streams of 1080p HD @ 5 fps each. Note: During archival operations, maximum no of playback streams recommended from Desktop Client and Web Client is 16 streams.
<b>ARCHIVAL PERFORMANCE</b>	16 channels @ 4 Mbps bitrate each / 64 Mbps total archival throughput capacity. Outgoing archival storage throughput of 200 Mbps.
<b>MULTI-STREAM PERFORMANCE</b>	Support for maximum 128 streams. Support for configuring 1 preferred stream for continuous recording and 1 preferred stream for live video / motion based recording per camera, subject to overall bandwidth / throughput.

MAXPRO NVR SERVER – VERSION 5.6 OR ABOVE UP TO 32, 48, 64 OR 128 CHANNELS	
<b>PROCESSOR</b>	Intel® Core™ i7-7700, 3.6 GHz or higher for up to 64 Channels, Xeon Silver 4110, 2.1 GHz or higher for 128 Channels
<b>SYSTEM MEMORY (RAM)</b>	Minimum 16 GB or higher for up to 64 Channels, minimum 32GB for 128 Channels
<b>OS &amp; APPLICATION – HARD DISK DRIVE OR PARTITION</b>	Minimum 200 GB Partition drive or separate hard drive
<b>GRAPHICS ADAPTER</b>	Minimum In-built Processor Graphics (GPU):Intel® HD Graphics 630 or equivalent for local client GPU rendering support
<b>NETWORK INTERFACE</b>	Minimum – 2 Gigabit network interface card
<b>OPTICAL DRIVE</b>	Optional DVD-RW
<b>VIDEO STORAGE DRIVE</b>	Video rated or Enterprise drive, 7200 RPM SATA/SAS recommended
<b>MONITOR RESOLUTION</b>	Video resolution 1280x1024 pixels or higher, 32 bit
<b>KEYBOARD/MOUSE</b>	102-key keyboard and mouse
<b>OPERATING SYSTEM OPTIONS</b>	Microsoft® Windows 10, Windows 10 IoT Enterprise for Embedded Systems, Windows Server 2008 R2, 2012 R2 and 2016
<b>DATABASE</b>	Microsoft® SQL Server® 2012 Express is automatically installed while installing MAXPRO NVR Server
SUPPORTED PERFORMANCE – 64-BIT WINDOWS OS	
<b>RECORDING AND MONITORING PERFORMANCE</b>	RAID/JBOD Video Storage with 6 GB/s SAS/SATA RAID Card: 128 channels with 3840 fps @ 4CIF/VGA or 3840 fps @ 720p HD or 3840 fps @ 1080p (4 Mbps bitrate) HD. 1-way audio for up to 128 IP channels. Network bandwidth/throughput: 800 Mbps. Rendering performance using GPU of up to 4 1080p HD @ 20 fps / 80 fps on local client. Note: Oncam Grandeye 360 cameras are not supported with GPU rendering and use CPU rendering by default.
<b>SERVER BASED VMD (SMART VMD) PERFORMANCE - CHANNELS SUPPORTED</b>	RAID/JBOD Video Storage with 6 GB/s SAS/SATA RAID Card: Channels at max fps-64 ch at 1920 fps @ 4CIF/VGA or 64 ch at 1920fps @ 720p or 64 ch at 1920fps @ 1080p or total 128 Megapixel. All Channels at fps-64 ch at 1920 fps @ 4CIF/VGA or 1920 fps @ 720p or 1920 fps @ 1080p or total 128 Megapixel. Smart VMD is not recommended when more than 64 cameras are connected to the NVR
<b>MAX VIDEO STREAMS SUPPORT</b>	Web Client: Live – 64 streams, Playback - 32 streams. Note: Live streams consumed are per camera being viewed live and duplicate live views of the same camera in multiple or same web client instance are allowed without consuming additional streams. Playback streams consumed are per playback stream being viewed and each playback stream being viewed consumes 1 additional stream. Desktop Client: Live - 256 streams, Playback/Video retrieval sessions - 32, Sync playback - 9 streams. 256 live streams limit excludes 1 stream used per camera if SMART VMD is enabled. Maximum live streams per camera is 15 with SMART VMD enabled. Mobile App: 16 streams of 1080p HD @ 5 fps each. Note: During archival operations, maximum no of playback streams recommended from Desktop Client and Web Client is 16 streams.
<b>ARCHIVAL PERFORMANCE</b>	RAID/JBOD Video Storage with 12 GB/s SAS/SATA RAID Card: 64 channels @ 2.5 Mbps / 160 Mbps total archival bandwidth while recording 128 channels @ 2.5 Mbps / 320 Mbps with total bandwidth/throughput 700 Mbps
<b>MULTI-STREAM PERFORMANCE</b>	Support for maximum 256 streams. Support for configuring 1 preferred stream for continuous recording and 1 preferred stream for live video / motion based recording per camera, subject to overall bandwidth / throughput.

# MAXPRO® NVR Software

## Network Video Recording Solution

### SOFTWARE SPECIFICATIONS

Operational – MAXPRO NVR Software	
IMAGE COMPRESSIONS SUPPORTED	MJPEG, MPEG-4, H.264, H.265
SUPPORTED HONEYWELL IP CAMERAS & ENCODERS	Supports Honeywell's Performance IP, eQIP® Series cameras. Refer to <a href="http://www.security.honeywell.com/hota/compatibility/index.html">www.security.honeywell.com/hota/compatibility/index.html</a>
SUPPORTED THIRD PARTY IP CAMERAS & ENCODERS	Refer to the MAXPRO® NVR Compatibility for a comprehensive list of compatible products to which this device is integrated. <a href="http://www.security.honeywell.com/hota/compatibility/index.html">www.security.honeywell.com/hota/compatibility/index.html</a>
AUDIO SUPPORT	1-way audio for specific IP camera models. Refer to <a href="http://www.security.honeywell.com/hota/compatibility/index.html">www.security.honeywell.com/hota/compatibility/index.html</a>
MAXIMUM NUMBER OF DESKTOP CLIENT CONNECTIONS	Desktop Client - 18 remote per server from 9 remote workstations + 1 local on NVR server.
SALVO LAYOUTS	Desktop Client - Full, 2x2, 1x5, 3x3, 2x8, 1x12, 4x4. Web Client - 2x2, 1x1, 1x2, 1x3. Mobile app (Phone) - 2x2, 2x4, 1x2, 1x1. Mobile app (Tablet) - 3x3, 2x2, 1x1.
PICTURE CONTROLS PER CAMERA	Sharpness, blur, brightness, contrast, hue, saturation, maintain aspect ratio, stretched, original size and picture mirror
OSD	Concealed text option
PLAYBACK CONTROLS PER CAMERA - DESKTOP CLIENT	FWD/REV Play x (1, 2, 4, 8, 16) Slow FWD/REV Play x (1/2, 1/4, 1/8)
SEARCH TYPES	Time/date timeline, time jump FWD/REV, bookmarks, calendar preview, film strip, event search and SMART Motion Search
RECORDING SCHEDULE	Continuous and event based with H/M/D and holiday and exception days
RECORDING METHODS PER CAMERA	Continuous, event-based and user activated
LIVE SETTINGS PER CAMERA	Compression format, resolution and frame rate
RECORDING SETTINGS PER CAMERA	Same as live or reduced frame rate
CLIP FORMAT	Honeywell MPVC playable with standalone MAXPRO Clip Player for faster and secure exports. WMV with digital certificate for authentication playable with Windows media player. ASF for faster exporting of longer than an hour backup clips in native compression format.
VIDEO CLIP AUTHENTICATION	Digital signature, verification tool provided
MOTION DETECTION LOCATION	Camera based for supported models or Server based (Smart VMD) for all models (except 360 fisheye/panomorph views)
EVENT RECORDING	Pre- and post-duration setting
OPERATOR REPORTING	Per user, configurator, session and viewer
EVENT REPORT	Per camera or recorder events
OPERATORS	1024

# MAXPRO® NVR Software

Network Video Recording Solution

## SYSTEM DIAGRAM

### MAXPRO NVR Standalone NVR System

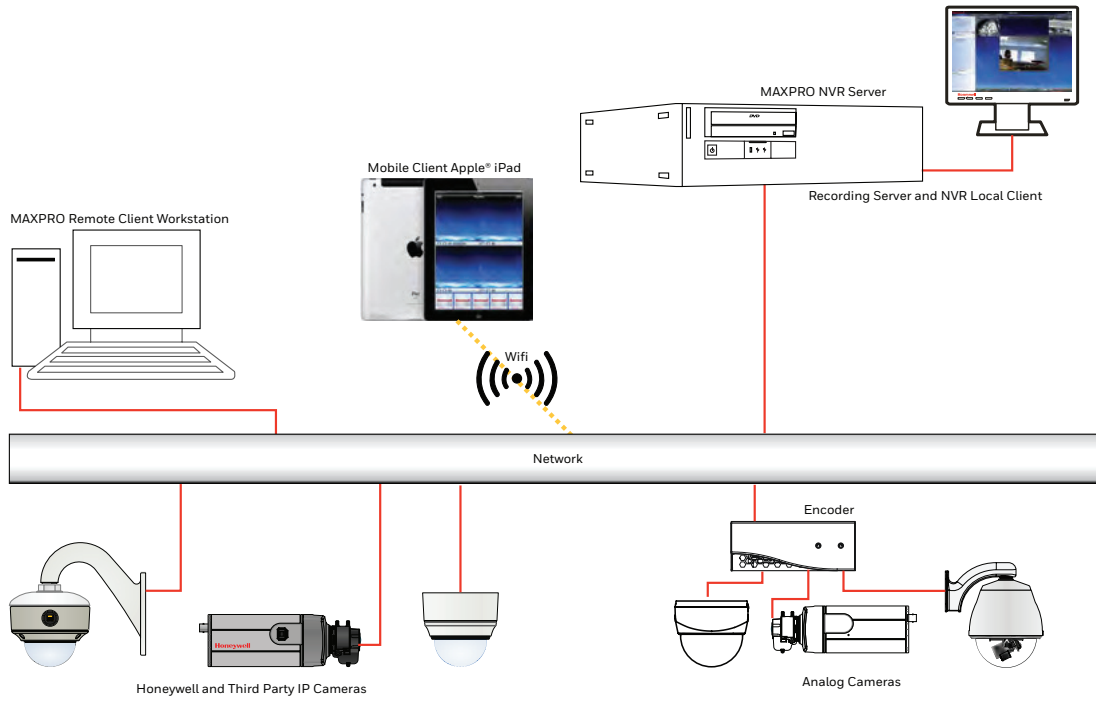

### MAXPRO NVR Multiple NVRs – Distributed Architecture

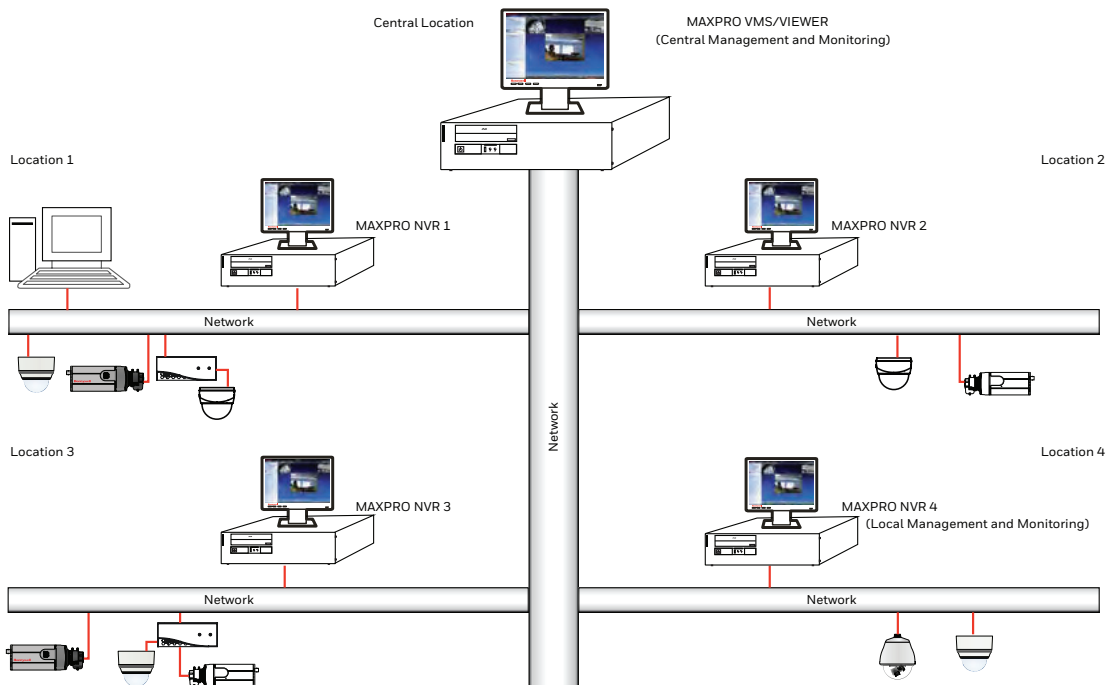

# MAXPRO® NVR Software

## Network Video Recording Solution

### ORDERING

#### MAXPRO NVR SOFTWARE

MPNVRSW128	MAXPRO NVR Software – Base Software and License for 128 Channels
MPNVRSW64	MAXPRO NVR Software – Base Software and License for 64 Channels
MPNVRSW48	MAXPRO NVR Software – Base Software and License for 48 Channels
MPNVRSW32	MAXPRO NVR Software – Base Software and License for 32 Channels
MPNVRSW16	MAXPRO NVR Software – Base Software and License for 16 Channels
MPNVRSW8	MAXPRO NVR Software – Base Software and License for 8 Channels
MPNVRSW4	MAXPRO NVR Software – Base Software and License for 4 Channels

#### MAXPRO NVR SOFTWARE – UPGRADE LICENSES

MPNVRSW1UP	MAXPRO NVR Software – 1 Channel License Upgrade to add support for up to 128 Channels per NVR
MPNVRSW4UP	MAXPRO NVR Software – 4 Channel License Upgrade to add support for up to 128 Channels per NVR
MPNVRSW8UP	MAXPRO NVR Software – 8 Channel License Upgrade to add support for up to 128 Channels per NVR
MPNVRSW16UP	MAXPRO NVR Software – 16 Channel License Upgrade to add support for up to 128 Channels per NVR
MPNVRSW32UP	MAXPRO NVR Software – 32 Channel License Upgrade to add support for up to 128 Channels per NVR
MPNVRSW64UP	MAXPRO NVR Software – 64 Channel License Upgrade to add support for up to 128 Channels per NVR

#### SOFTWARE MAINTENANCE & UPGRADES AGREEMENTS FOR MAXPRO NVR SOFTWARE

SMUMPNVR4	Annual Software Maintenance & Upgrades Agreement – MAXPRO NVR Software System, up to 4 Channels
SMUMPNVR8	Annual Software Maintenance & Upgrades Agreement – MAXPRO NVR Software System, up to 8 Channels
SMUMPNVR16	Annual Software Maintenance & Upgrades Agreement – MAXPRO NVR Software System, up to 16 Channels
SMUMPNVR32	Annual Software Maintenance & Upgrades Agreement – MAXPRO NVR Software System, up to 32 Channels
SMUMPNVR48	Annual Software Maintenance & Upgrades Agreement – MAXPRO NVR Software System, up to 48 Channels
SMUMPNVR64	Annual Software Maintenance & Upgrades Agreement – MAXPRO NVR Software System, up to 64 Channels
SMUMPNVR128	Annual Software Maintenance & Upgrades Agreement – MAXPRO NVR Software System, up to 128 Channels
SMU24MPNVR4	Annual 24/7 Software Maintenance & Upgrades Agreement – MAXPRO NVR Software System, up to 4 Channels
SMU24MPNVR8	Annual 24/7 Software Maintenance & Upgrades Agreement – MAXPRO NVR Software System, up to 8 Channels
SMU24MPNVR16	Annual 24/7 Software Maintenance & Upgrades Agreement – MAXPRO NVR Software System, up to 16 Channels
SMU24MPNVR32	Annual 24/7 Software Maintenance & Upgrades Agreement – MAXPRO NVR Software System, up to 32 Channels
SMU24MPNVR48	Annual 24/7 Software Maintenance & Upgrades Agreement – MAXPRO NVR Software System, up to 48 Channels
SMU24MPNVR64	Annual 24/7 Software Maintenance & Upgrades Agreement – MAXPRO NVR Software System, up to 64 Channels
SMU24MPNVR128	Annual 24/7 Software Maintenance & Upgrades Agreement – MAXPRO NVR Software System, up to 128 Channels

#### For more information

[www.security.honeywell.com](http://www.security.honeywell.com)

#### Honeywell Commercial Security

715 Peachtree St. NE  
Atlanta, GA 30308  
1.800.323.4576  
[www.honeywell.com](http://www.honeywell.com)

ONVIF and the ONVIF logo are trademarks of ONVIF Inc. Honeywell reserves the right, without notification, to make changes in product design or specifications.

HSV-MPSW-02-US(0619)DS-Z  
© 2019 Honeywell International Inc.

THE  
FUTURE  
IS  
WHAT  
WE  
MAKE IT

**Honeywell**