

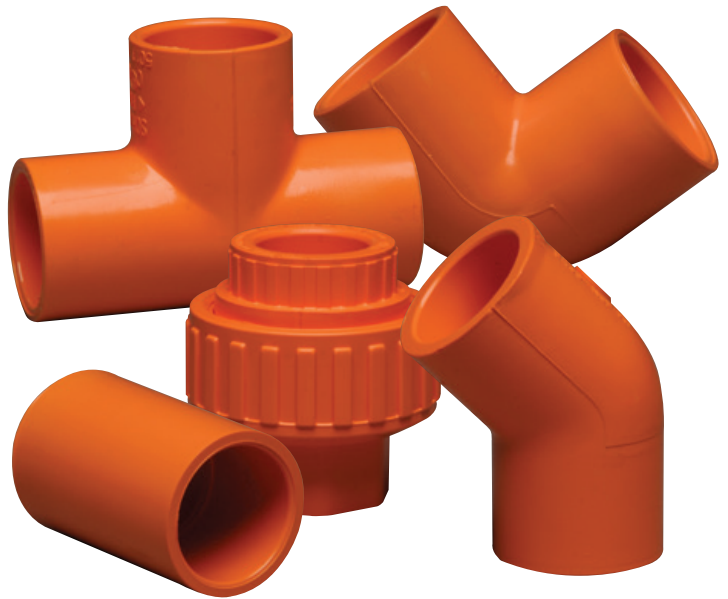

# Aspiration Accessories

Complete aspiration pipe networks with CPVC pipe, fittings and related accessories.



## Available Accessories

- F-A3384-000 Replacement 8000 Series Air Filter
- P-COUPLING Coupling
- P-ELB-45 45° CPVC Elbow
- P-ELB-90 90° CPVC Elbow
- P-ENDCAP CPVC End Cap
- P-LABEL-P Sampling Point Labels
- P-LABEL-T Pipe Labels
- P-PIPE-210 CPVC Pipe
- P-SAMP-KTC Sampling Kit with Conical Points
- P-SAMP-KTF Sampling Kit with Flush Points
- P-TEE CPVC Tee Fitting
- P-UNION CPVC Union

## Agency Listings (Fittings)



CPVC FIRE SPRINKLER FITTING 7TA2



## Agency Listings (Pipes)



S911

NOTE: P-PIPE-210 piping products have been investigated by Underwriters Laboratories (C-UL-US) for listings in the United States and Canada, per the requirements of UL1887, complies with the combustibility requirements for thermoplastic sprinkler pipe as described in the Standard for Installation of Air Conditioning and Ventilating Systems, ULC/ORD-C119P-2002, "Combustible Piping for Sprinkler Systems," and meets NFPA 90A and various model mechanical codes.

When installing the FAAST aspirating smoke detector, the accessories listed on this sheet include all the pipe, fittings<sup>†</sup> and related elements required to complete pipe networks designed in the FAAST PipelQ™ software.

The **P-PIPE-210** consists of 14 lengths of 15-foot CPVC piping ideal for meeting UL-listed pipe network specifications. Fittings, including **P-COUPLING**, **P-ELB-45**, **P-ELB-90**, **P-ENDCAP**, **P-TEE** and **P-UNION**, are all ¾" nominal Schedule 40 CPVC fittings to make necessary pipe network connections, turns and terminations. Fittings are rated for continuous service of 175 psi (1,270 kPa) at 150°F (65°C).

Capillary sampling kits are available with all the components necessary to bring above-the-ceiling pipe networks down to drop ceilings, equipment, etc. Each kit includes 10 sets of ¾" x ¾" x ½" MNPT CPVC Tee fitting, ¾" to ½" MNPT fitting, 10 sets of 14 foot of flexible capillary tubing (¾" x ¼"), and 10 sample point fittings with a 1/16" pre-drilled hole and "Air Sampling Point" label. The **P-SAMP-KTC** contains conical shaped sampling points and the **P-SAMP-KTF** contains flush sampling points.

The **P-LABEL-P** and **P-LABEL-T** are rolls of 100 1" x 3" sampling point and pipe labels that caution trades from tampering with the pipe network. The P-LABEL-P is marked "Fire Detection System Sampling Point DO NOT PAINT." The P-LABEL-T is marked "SMOKE DETECTOR SAMPLING TUBE DO NOT DISTURB."

72 hours before the filter must be cleaned or replaced, the Series 8000 FAAST aspiration detector provides a minor fault. The filter, which resides under the language display card for easy access, can then be replaced by the **F-A3384-000** replacement air filter. This filter includes a 30 micron filter element and plastic housing in a single module to reduce service time and labor.

<sup>†</sup> All pipe and fittings are post-chlorinated polyvinyl chloride (CPVC) made with BlazeMaster resin. BlazeMaster is a trademark of Lubrizol Advanced Materials, Inc.

## Specifications, Aspiration Accessories

Part Number	Item	Nominal Dia	Approx Wt/ lbs	A Dim	B Dim	C Dim	J Dim	L Dim	Fitting	Carton Qty
P-ENDCAP	Endcap	3/4"	0.04	0.31	—	—	—	—	S-Slip	25
P-COUPLING	Coupling	3/4"	0.06	0.12	—	—	—	—	SXS	15
P-ELB-45	45° Elbow	3/4"	0.06	—	—	—	0.32	—	SXS	10
P-ELB-90	90° Elbow	3/4"	0.08	0.56	0.56	—	—	—	SXS	20
P-TEE	Tee Fitting	3/4"	0.10	0.57	0.57	0.57	—	—	SXSXS	15
P-UNION	Union	3/4"	0.27	2.46	—	—	—	0.43	SXS	10



**P-ENDCAP** End Cap

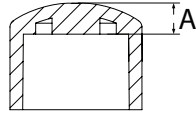

**P-COUPLING** Coupling

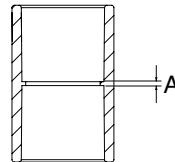

**P-ELB-45** 45 Degree Elbow

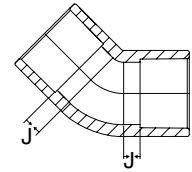

**P-ELB-90** 90 Degree Elbow

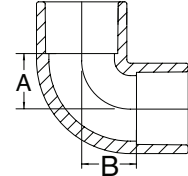

**P-TEE** Tee

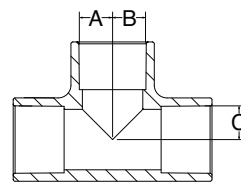

**P-UNION** Union

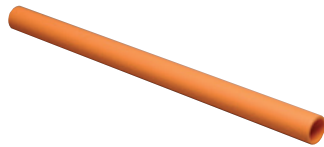
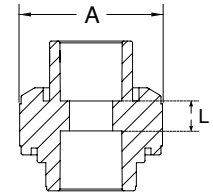

**P-PIPE-210** CPVC Pipe



**P-LABEL-P** Sampling Point Label



**P-LABEL-T** Pipe Label



**F-A3384-000** Air Filter



**P-SAMP-KTC / P-SAMP-KTF** Sampling Kit

## Ordering Information

Part No.	Description	Part No.	Description
<b>Accessories</b>			
P-PIPE-210	15 ft. lengths, 3/4" Orange CPVC pipe, 14 pieces, 210 ft. Total Length	P-ENDCAP	CPVC End Cap, 3/4", qty. 25
P-ELB-90	90 degree CPVC Elbow, 3/4", Socket to Socket, qty. 20	P-LABEL-P	Sampling Point Labels, roll of 100
P-ELB-45	45 degree CPVC Elbow, 3/4", Socket to Socket, qty. 10	P-LABEL-T	Pipe Labels, roll of 100
P-TEE	90 degree CPVC Tee, 3/4", Socket to Socket, qty. 15	P-SAMP-KTC	Sampling Kit with Conical Points, set of 10
P-COUPLING	CPVC Coupling, 3/4", Socket to Socket, qty. 15	P-SAMP-KTF	Sampling Kit with FlushPoints, set of 10
P-UNION	CPVC Socket Union, 3/4", qty. 10	F-A3384-000	Replacement 8000 Series Air Filter



3825 Ohio Avenue • St. Charles, IL 60174  
 Phone: 800-SENSOR2 • Fax: 630-377-6495  
 www.systemsensor.com

©2017 System Sensor.  
 Product specifications subject to change without notice. Visit systemsensor.com  
 for current product information, including the latest version of this data sheet.  
 ASDS68003 • 05/17