

MAXPRO[®] NVR SOFTWARE

Network Video Recording Solution



MAXPRO NVR SERVER – VERSION 5.6 OR ABOVE UP TO 8 OR 16 CHANNELS

PROCESSOR	Intel® Core™ i5-7500, 3.4 GHz or higher
SYSTEM MEMORY (RAM)	Minimum 8 GB or higher
OS & APPLICATION – HARD DISK DRIVE OR PARTITION	Minimum 200 GB Partition drive or separate hard drive
GRAPHICS ADAPTER	Minimum In-built Processor Graphics (GPU):Intel® HD Graphics 630 or equivalent for local client GPU rendering support
NETWORK INTERFACE	Minimum – 2 Gigabit network interface card
OPTICAL DRIVE	Optional DVD-RW
VIDEO STORAGE DRIVE	Video rated or Enterprise drive, 7200 RPM SATA/SAS recommended
MONITOR RESOLUTION	Video resolution 1280x1024 pixels or higher, 32 bit
KEYBOARD / MOUSE	102-key keyboard and mouse
OPERATING SYSTEM OPTIONS	Microsoft® Windows 10, Windows 10 IoT Enterprise for Embedded Systems, Windows Server 2008 R2, 2012 R2 and 2016
DATABASE	Microsoft® SQL Server® 2012 Express is automatically installed while installing MAXPRO NVR Server

SUPPORTED PERFORMANCE – 64-BIT WINDOWS OS

RECORDING AND MONITORING PERFORMANCE	16 channels with 480 fps @ 4CIF/VGA or 480 fps @ 720p HD or 480 fps @ 1080p (4 Mbps bitrate) HD. 1-way audio for up to 8 or 16 IP channels. Network bandwidth/throughput supported per NVR with Incoming: 65 Mbps, Outgoing:180 Mbps providing a Total: 245 Mbps.Rendering performance using GPU of up to 4 1080p HD @ 30 fps / 120 fps on local client. Note: Oncam Grandeye 360 cameras are not supported with GPU rendering and use CPU rendering by default.
---	--

SERVER BASED VMD (SMART VMD) PERFORMANCE – CHANNELS SUPPORTED	All 8 or 16 channels supported at 480 fps @ 4CIF/VGA or 480 fps @ 720p HD or 480 fps @ 1080p HD or total 32 Megapixel.
--	--

MAX VIDEO STREAMS SUPPORT	Web Client: Live - 64 streams, Playback - 32 streams. Note: Live streams consumed are per camera being viewed live and duplicate live views of the same camera in multiple or same web client instance are allowed without consuming additional streams. Playback streams consumed are per playback stream being viewed and each playback stream being viewed consumes 1 additional stream. Desktop Client: Live - 256 streams, Playback/Video retrieval sessions - 32.Sync playback - 9 streams 256 live streams limit excludes 1 stream used per camera if SMART VMD is enabled. Maximum live streams per camera is 15 with SMART VMD enabled. Mobile App: 16 streams of 1080p HD @ 5 fps each. Note: During archival operations,maximum no of playback streams recommended from Desktop Client and Web Client is 16 streams.
----------------------------------	---

ARCHIVAL PERFORMANCE	16 channels @ 4 Mbps bitrate each / 64 Mbps total archival throughput capacity. Outgoing archival storage throughput of 200 Mbps.
-----------------------------	---

MULTI-STREAM PERFORMANCE	Support for maximum 128 streams. Support for configuring 1 preferred stream for continuous recording and 1 preferred stream for live video / motion based recording per camera, subject to overall bandwidth / throughput.
---------------------------------	--

MAXPRO NVR SERVER – VERSION 5.6 OR ABOVE UP TO 32, 48, 64 OR 128 CHANNELS

PROCESSOR	Intel® Core™ i7-7700, 3.6 GHz or higher for up to 64 Channels, Xeon Silver 4110, 2.1 GHz or higher for 128 Channels
SYSTEM MEMORY (RAM)	Minimum 16 GB or higher for up to 64 Channels, minimum 32GB for 128 Channels
OS & APPLICATION – HARD DISK DRIVE OR PARTITION	Minimum 200 GB Partition drive or separate hard drive
GRAPHICS ADAPTER	Minimum In-built Processor Graphics (GPU):Intel® HD Graphics 630 or equivalent for local client GPU rendering support
NETWORK INTERFACE	Minimum – 2 Gigabit network interface card
OPTICAL DRIVE	Optional DVD-RW
VIDEO STORAGE DRIVE	Video rated or Enterprise drive, 7200 RPM SATA/SAS recommended
MONITOR RESOLUTION	Video resolution 1280x1024 pixels or higher, 32 bit
KEYBOARD/MOUSE	102-key keyboard and mouse
OPERATING SYSTEM OPTIONS	Microsoft® Windows 10, Windows 10 IoT Enterprise for Embedded Systems, Windows Server 2008 R2, 2012 R2 and 2016
DATABASE	Microsoft® SQL Server® 2012 Express is automatically installed while installing MAXPRO NVR Server

SUPPORTED PERFORMANCE – 64-BIT WINDOWS OS

RECORDING AND MONITORING PERFORMANCE	RAID/JBOD Video Storage with 6 GB/s SAS/SATA RAID Card: 128 channels with 3840 fps @ 4CIF/VGA or 3840 fps @ 720p HD or 3840 fps @ 1080p (4 Mbps bitrate) HD.1-way audio for up to 128 IP channels. Network bandwidth/throughput: 800 Mbps. Rendering performance using GPU of up to 4 1080p HD @ 20 fps / 80 fps on local client. Note: Oncam Grandeye 360 cameras are not supported with GPU rendering and use CPU rendering by default.
---	---

SERVER BASED VMD (SMART VMD) PERFORMANCE – CHANNELS SUPPORTED	RAID/JBOD Video Storage with 6 GB/s SAS/SATA RAID Card: Channels at max fps-64 ch at 1920 fps @ 4CIF/VGA or 64 ch at 1920fps @ 720p or 64 ch at 1920fps @ 1080p or total 128 Megapixel. All Channels at fps-64 ch at 1920 fps @ 4CIF/VGA or 1920 fps @ 720p or 1920 fps @ 1080p or total 128 Megapixel. Smart VMD is not recommended when more than 64 cameras are connected to the NVR
--	---

MAX VIDEO STREAMS SUPPORT	Web Client: Live – 64 streams, Playback – 32 streams. Note: Live streams consumed are per camera being viewed live and duplicate live views of the same camera in multiple or same web client instance are allowed without consuming additional streams. Playback streams consumed are per playback stream being viewed and each playback stream being viewed consumes 1 additional stream. Desktop Client: Live - 256 streams, Playback/Video retrieval sessions - 32, Sync playback - 9 streams. 256 live streams limit excludes 1 stream used per camera if SMART VMD is enabled. Maximum live streams per camera is 15 with SMART VMD enabled. Mobile App: 16 streams of 1080p HD @ 5 fps each. Note: During archival operations,maximum no of playback streams recommended from Desktop Client and Web Client is 16 streams.
----------------------------------	---

ARCHIVAL PERFORMANCE	RAID/JBOD Video Storage with 12 GB/s SAS/SATA RAID Card: 64 channels @ 2.5 Mbps / 160 Mbps total archival bandwidth while recording 128 channels @ 2.5 Mbps / 320 Mbps with total bandwidth/throughput 700 Mbps
-----------------------------	---

MULTI-STREAM PERFORMANCE	Support for maximum 256 streams. Support for configuring 1 preferred stream for continuous recording and 1 preferred stream for live video / motion based recording per camera, subject to overall bandwidth / throughput.
---------------------------------	--

MAXPRO® NVR Software

Network Video Recording Solution

SOFTWARE SPECIFICATIONS

Operational – MAXPRO NVR Software	
IMAGE COMPRESSIONS SUPPORTED	MJPEG, MPEG-4, H.264, H.265
SUPPORTED HONEYWELL IP CAMERAS & ENCODERS	Supports Honeywell's Performance IP, eQulP® Series cameras. Refer to www.security.honeywell.com/hota/compatibility/index.html
SUPPORTED THIRD PARTY IP CAMERAS & ENCODERS	Refer to the MAXPRO® NVR Compatibility for a comprehensive list of compatible products to which this device is integrated. www.security.honeywell.com/hota/compatibility/index.html
AUDIO SUPPORT	1-way audio for specific IP camera models. Refer to www.security.honeywell.com/hota/compatibility/index.html
MAXIMUM NUMBER OF DESKTOP CLIENT CONNECTIONS	Desktop Client - 18 remote per server from 9 remote workstations + 1 local on NVR server.
SALVO LAYOUTS	Desktop Client - Full, 2x2, 1x5, 3x3, 2x8, 1x12, 4x4. Web Client - 2x2, 1x1, 1x2, 1x3. Mobile app (Phone) - 2x2, 2x4, 1x2, 1x1. Mobile app (Tablet) - 3x3, 2x2, 1x1.
PICTURE CONTROLS PER CAMERA	Sharpness, blur, brightness, contrast, hue, saturation, maintain aspect ratio, stretched, original size and picture mirror
OSD	Concealed text option
PLAYBACK CONTROLS PER CAMERA - DESKTOP CLIENT	FWD/REV Play x (1, 2, 4, 8, 16) Slow FWD/REV Play x (1/2, 1/4, 1/8)
SEARCH TYPES	Time/date timeline, time jump FWD/REV, bookmarks, calendar preview, film strip, event search and SMART Motion Search
RECORDING SCHEDULE	Continuous and event based with H/M/D and holiday and exception days
RECORDING METHODS PER CAMERA	Continuous, event-based and user activated
LIVE SETTINGS PER CAMERA	Compression format, resolution and frame rate
RECORDING SETTINGS PER CAMERA	Same as live or reduced frame rate
CLIP FORMAT	Honeywell MPVC playable with standalone MAXPRO Clip Player for faster and secure exports. WMV with digital certificate for authentication playable with Windows media player. ASF for faster exporting of longer than an hour backup clips in native compression format.
VIDEO CLIP AUTHENTICATION	Digital signature, verification tool provided
MOTION DETECTION LOCATION	Camera based for supported models or Server based (Smart VMD) for all models (except 360 fisheye/panomorph views)
EVENT RECORDING	Pre- and post-duration setting
OPERATOR REPORTING	Per user, configurator, session and viewer
EVENT REPORT	Per camera or recorder events
OPERATORS	1024

MAXPRO® NVR Software

Network Video Recording Solution

SYSTEM DIAGRAM

MAXPRO NVR Standalone NVR System

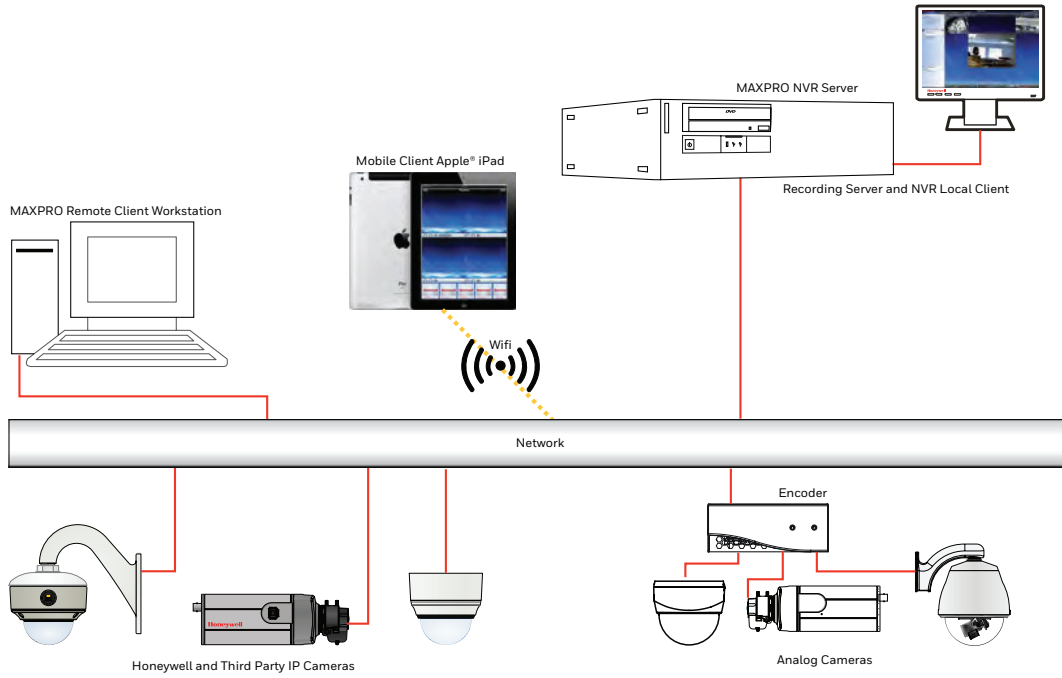

MAXPRO NVR Multiple NVRs – Distributed Architecture

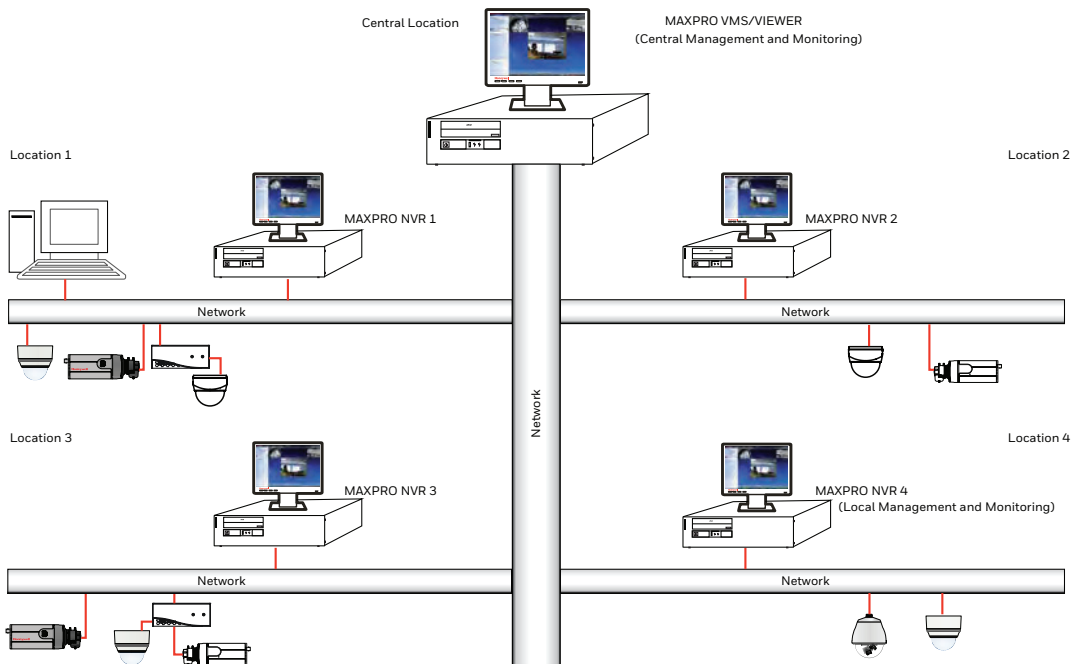

MAXPRO® NVR Software

Network Video Recording Solution

ORDERING

MAXPRO NVR SOFTWARE

MPNVRSW128	MAXPRO NVR Software – Base Software and License for 128 Channels
MPNVRSW64	MAXPRO NVR Software – Base Software and License for 64 Channels
MPNVRSW48	MAXPRO NVR Software – Base Software and License for 48 Channels
MPNVRSW32	MAXPRO NVR Software – Base Software and License for 32 Channels
MPNVRSW16	MAXPRO NVR Software – Base Software and License for 16 Channels
MPNVRSW8	MAXPRO NVR Software – Base Software and License for 8 Channels
MPNVRSW4	MAXPRO NVR Software – Base Software and License for 4 Channels

MAXPRO NVR SOFTWARE – UPGRADE LICENSES

MPNVRSW1UP	MAXPRO NVR Software – 1 Channel License Upgrade to add support for up to 128 Channels per NVR
MPNVRSW4UP	MAXPRO NVR Software – 4 Channel License Upgrade to add support for up to 128 Channels per NVR
MPNVRSW8UP	MAXPRO NVR Software – 8 Channel License Upgrade to add support for up to 128 Channels per NVR
MPNVRSW16UP	MAXPRO NVR Software – 16 Channel License Upgrade to add support for up to 128 Channels per NVR
MPNVRSW32UP	MAXPRO NVR Software – 32 Channel License Upgrade to add support for up to 128 Channels per NVR
MPNVRSW64UP	MAXPRO NVR Software – 64 Channel License Upgrade to add support for up to 128 Channels per NVR

SOFTWARE MAINTENANCE & UPGRADES AGREEMENTS FOR MAXPRO NVR SOFTWARE

SMUMPNVR4	Annual Software Maintenance & Upgrades Agreement – MAXPRO NVR Software System, up to 4 Channels
SMUMPNVR8	Annual Software Maintenance & Upgrades Agreement – MAXPRO NVR Software System, up to 8 Channels
SMUMPNVR16	Annual Software Maintenance & Upgrades Agreement – MAXPRO NVR Software System, up to 16 Channels
SMUMPNVR32	Annual Software Maintenance & Upgrades Agreement – MAXPRO NVR Software System, up to 32 Channels
SMUMPNVR48	Annual Software Maintenance & Upgrades Agreement – MAXPRO NVR Software System, up to 48 Channels
SMUMPNVR64	Annual Software Maintenance & Upgrades Agreement – MAXPRO NVR Software System, up to 64 Channels
SMUMPNVR128	Annual Software Maintenance & Upgrades Agreement – MAXPRO NVR Software System, up to 128 Channels
SMU24MPNVR4	Annual 24/7 Software Maintenance & Upgrades Agreement – MAXPRO NVR Software System, up to 4 Channels
SMU24MPNVR8	Annual 24/7 Software Maintenance & Upgrades Agreement – MAXPRO NVR Software System, up to 8 Channels
SMU24MPNVR16	Annual 24/7 Software Maintenance & Upgrades Agreement – MAXPRO NVR Software System, up to 16 Channels
SMU24MPNVR32	Annual 24/7 Software Maintenance & Upgrades Agreement – MAXPRO NVR Software System, up to 32 Channels
SMU24MPNVR48	Annual 24/7 Software Maintenance & Upgrades Agreement – MAXPRO NVR Software System, up to 48 Channels
SMU24MPNVR64	Annual 24/7 Software Maintenance & Upgrades Agreement – MAXPRO NVR Software System, up to 64 Channels
SMU24MPNVR128	Annual 24/7 Software Maintenance & Upgrades Agreement – MAXPRO NVR Software System, up to 128 Channels

For more information

www.security.honeywell.com/uk
www.security.honeywell.com/me

Honeywell Commercial Security

Honeywell Security Office -
Emaar Business Park, Sheikh Zayed Road
Building No. 2, 2nd floor, 201
Post Office Box 232362
Dubai, United Arab Emirates
Tel: +971 44541704

Honeywell Commercial Security

Aston Fields Road
Whitehouse Industrial Estate
Runcorn, Cheshire, WA7 3DL
United Kingdom
Tel: +44 (0)8448 000 235
www.honeywell.com

ONVIF and the ONVIF logo are trademarks of ONVIF Inc. Honeywell reserves the right, without notification, to make changes in product design or specifications.

HSV-MPSW-02-UK(0619)DS-Z
© 2019 Honeywell International Inc.

THE
FUTURE
IS
WHAT
WE
MAKE IT

Honeywell