

## Flush Mounting

### Securing Back Box to Wall for Flush Mounting

Attach second set of wires to top of back box.

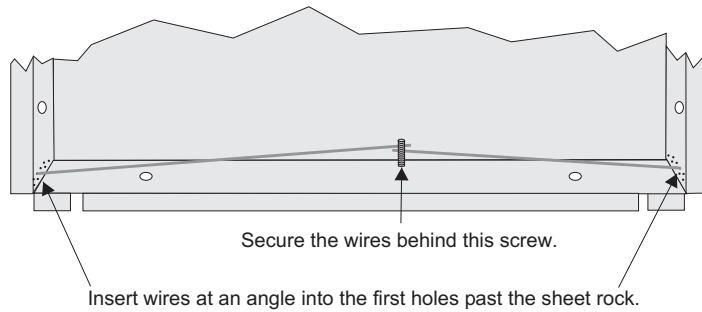

### Flush Mounting with Electrical Box (Example)

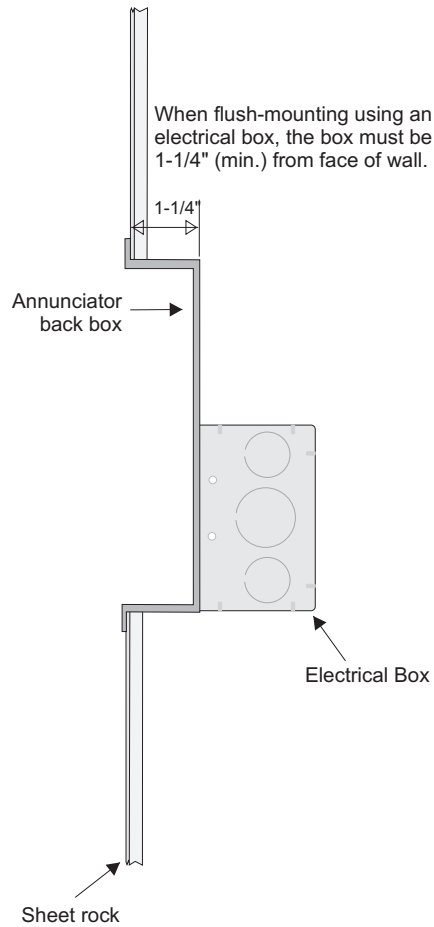

**SILENT  
KNIGHT**

## Model 5860 Remote Fire Annunciator Installation Quick Reference

Refer to 5820 installation manual (P/N 150972) for complete information.

### Installation Steps

1. Make sure power is off at the panel.
2. Annunciator is assembled at the factory. Disassemble as needed.
3. Mount annunciator. See pages 3-4.
4. Wire annunciator to the panel. See page 2.
5. Use dipswitches to set annunciator ID. See page 2.

### Annunciator Parts

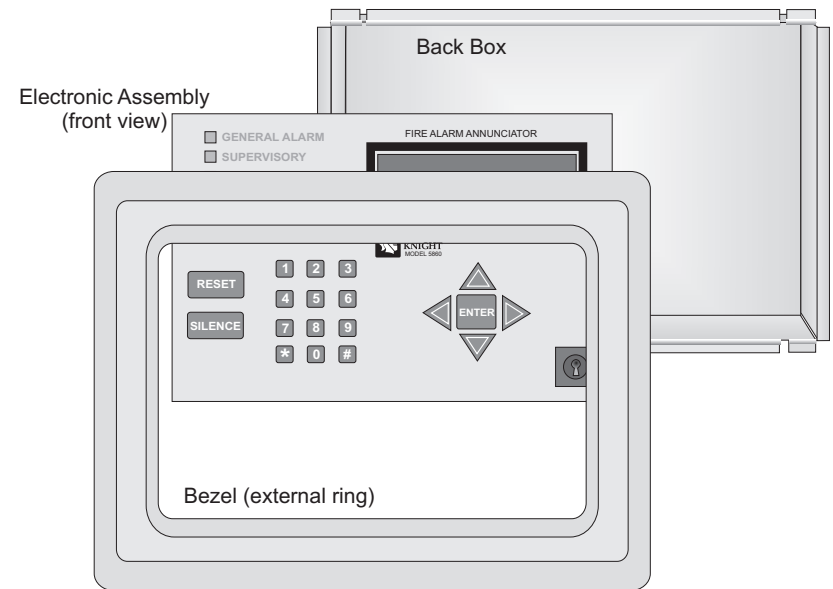

Assembled annunciator also includes mounting wires, 2 set screws.

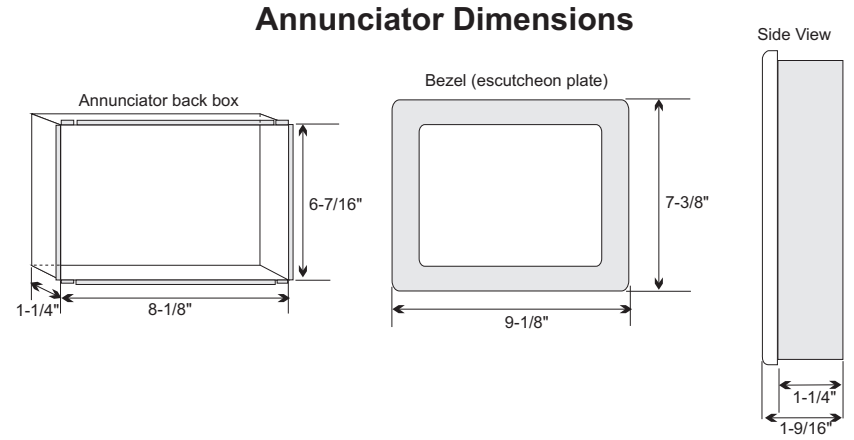
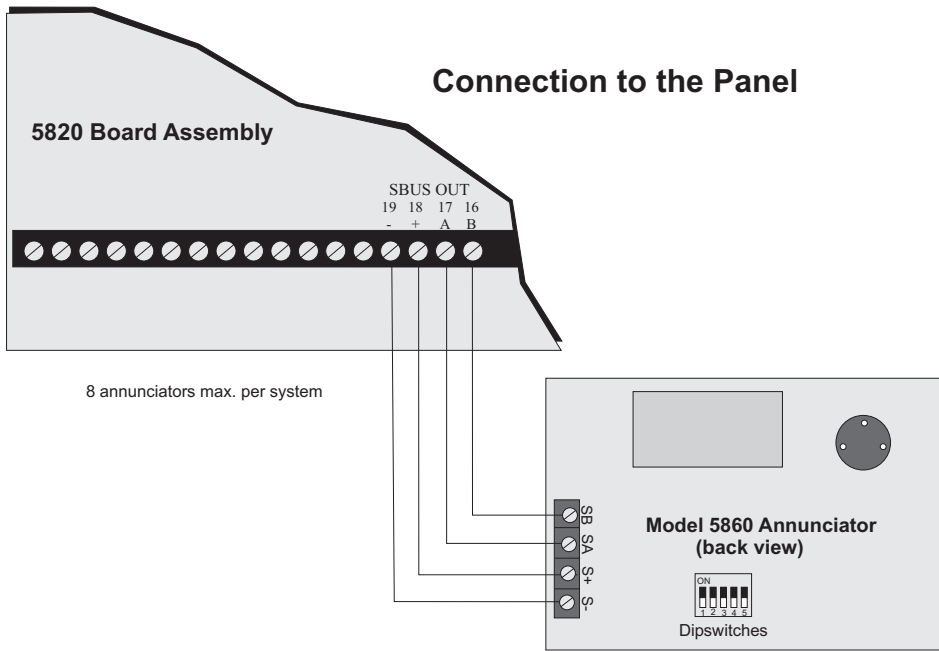

### Possible ID Numbers

1 2 3 4 5	Address	1 2 3 4 5	Address
□□□□□	*0	□□□□□	16
■□□□□	1	■□□□□	17
□■□□□	2	□■□□□	18
□□■□□	3	□□■□□	19
□□□■□	4	□□□■□	20
□□□□■	5	□□□□■	21
■□□□□	6	■□□□□	22
□■□□□	7	□■□□□	23
□□■□□	8	□□■□□	24
□□□■□	9	□□□■□	25
□□□□■	10	□□□□■	26
■□□□□	11	■□□□□	27
□■□□□	12	□■□□□	28
□□■□□	13	□□■□□	29
□□□■□	14	□□□■□	30
□□□□■	15	□□□□■	31

ON   
OFF

\*Note: Address 0 cannot be used.

### Surface Mounting

The Model \*5860T-G/R Trim Ring is available to provide a finished look to surface-mounted annunciators.

\*5860T-G is gray  
5860T-R is red

