



**SYSTEM
SENSOR®**



MP120KLA

120 VAC Adapter Mounting Plate

6335 Edwards Blvd. Mississauga, ON L5T 2W7
800/736-7672, FAX: 905-812-0771
www.systemsensor.ca

PRODUCT SPECIFICATIONS

Standard Operating Temperature:	-40°F to 151°F (-40°C to 66°C)
Humidity Range:	10 to 93% non-condensing (indoor products)
Nominal Voltage:	Regulated 120 VAC
Operating Voltage Range:	96-132 VAC
Current Draw From AC Line:	150 mA max.

MP120KLA may be used with any standard L-Series indoor Horns, Strobes, or Horn Strobes, at all horn and strobe settings.

NOTICE: This manual shall be left with the owner/user of this equipment.

GENERAL DESCRIPTION

The MP120KLA mounting plate is designed to allow the use of 120 VAC to power L-Series indoor horn, strobes, horn strobes, chimes, and chime strobes. The MP120KLA consists of a mounting plate that has been fitted with a power supply that converts 120VAC to nominal 24V FWR.

The MP120KLA must be installed using a 120 VAC power source. This unit can only be used for non-synchronous applications; it will NOT work with System Sensor Sync•Circuit Modules.

WIRING

This module has pig-tail wires and is intended to be wired without rigid connections inside a standard electrical box.

MOUNTING (WALL)

1. For indoor applications, attach the mounting plate as shown in Figure 2. The mounting plate is compatible only with 4 × 4 electrical boxes.
2. Connect field wiring. (For indoor models only)
3. If the product is not to be installed at this point, use the protective dust cover to prevent contamination of the mounting plate terminals.
4. To attach product to mounting plate:
 - a. Remove the protective dust cover.
 - b. Hook the tabs on the top of the product housing into the grooves on mounting plate.
 - c. Pivot the product into position to engage the terminals on the mounting plate. Make sure that the tabs on the back of the product housing fully engage with the mounting plate.
 - d. Hold product in place with one hand, and secure product by tightening the single mounting screw in the front of the product housing.

FIGURE 1. NON-SYNCHRONIZED DEVICES; ANY COMBINATION OF MODELS POWERED BY A 2-WIRE CIRCUIT

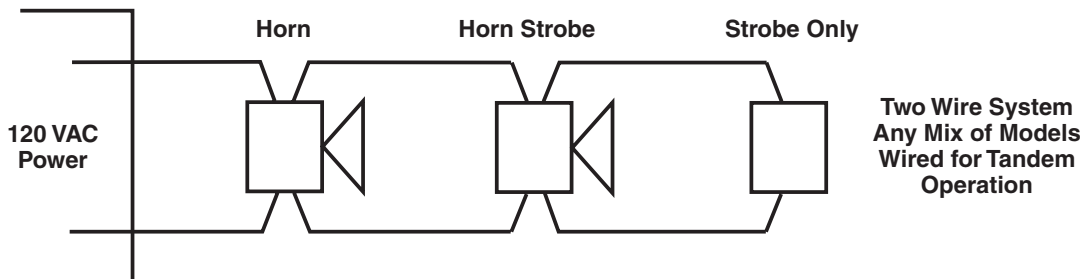

A0356-01

FIGURE 2. WALL-MOUNTING (INDOOR ONLY)

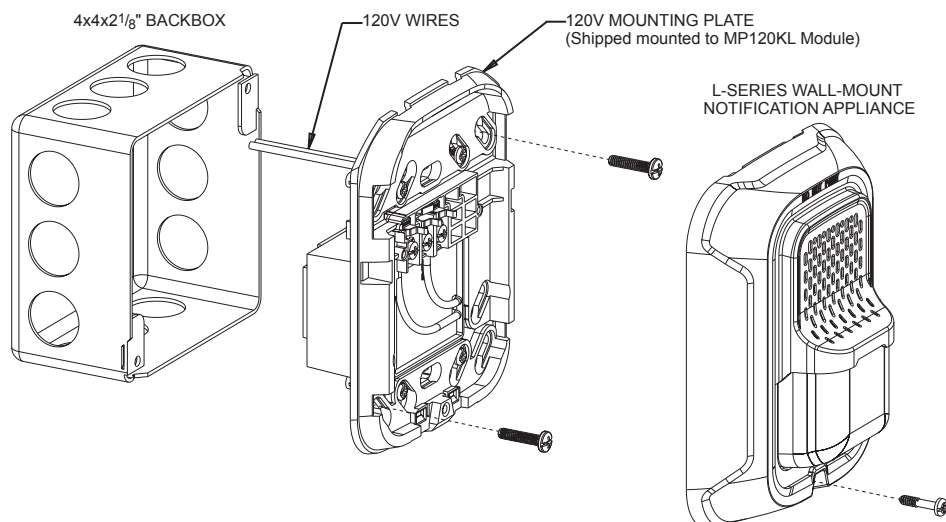

A0526CDN-01

MOUNTING (CEILING)

Indoor L-Series ceiling appliances use a round mounting plate that is not supplied with the MP120KLA. The mounting plate that ships with the notification appliance will need to be attached to the MP120KLA module.

1. Remove the mounting plate which comes attached to the MP120KLA module. Disconnect the red and black wire and remove the 4 mounting screws that attach the mounting plate to the MP120KLA module.
2. Attach the round mating plate that ships with the notification appliance to the MP120KLA module. Attach with the 4 screws from Step 1 and attach the red and black wires to the terminal screws.
3. Attach the mounting plate as shown in Figure 3. The mounting plate is compatible only with 4 × 4 electrical boxes.
4. Connect field wiring to the mounting plate per the notification appliance user manual.

5. If the product is not to be installed at this point, use the protective dust cover to prevent contamination of the mounting plate terminals.
6. To attach product to mounting plate:
 - a. Remove the protective dust cover.
 - b. Hook the tabs on the top of the product housing into the grooves on mounting plate.
 - c. Pivot the product into position to engage the terminals on the mounting plate. Make sure that the tabs on the back of the product housing fully engage with the mounting plate.
 - d. Hold product in place with one hand, and secure product by tightening the single mounting screw in the front of the product housing.

Ceiling Models only: To remove product from the mounting plate, loosen the captive mounting screw and press the locking button.

FIGURE 3. CEILING-MOUNTING (INDOOR ONLY)

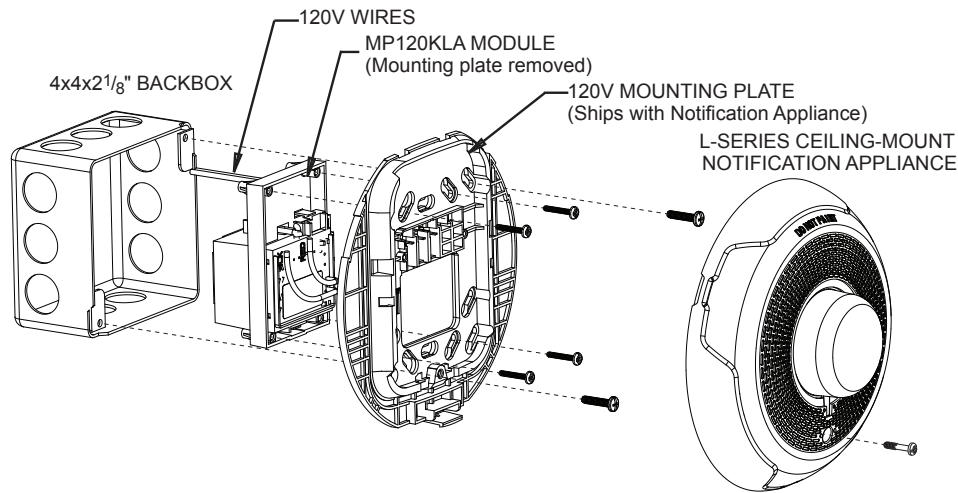

A0573CDN-00

FCC STATEMENT

System Sensor Strobes and Horn/Strobes have been tested and found to comply with the limits for a Class B digital device, pursuant to part 15 of the FCC Rules. These limits are designed to provide reasonable protection against harmful interference when the equipment is operated in a commercial environment. This equipment generates, uses, and can radiate radio frequency energy and, if not installed and used in accordance with the

instruction manual, may cause harmful interference to radio communications. Operation of this equipment in a residential area is likely to cause harmful interference in which case the user will be required to correct the interference at his own expense. This class B digital apparatus complies with Canadian ICES-003.

SUPPLEMENTAL INFORMATION

For the latest Warranty information, please go to:
<http://www.systemsensor.com/en-us/Documents/E56-4000.pdf>

For Limitations of Fire Alarm Systems, please go to:
<http://www.systemsensor.com/en-us/Documents/I56-1558.pdf>

Speakers only: For the latest Important Assembly Information, please go to:
<http://www.systemsensor.com/en-us/Documents/I56-6556.pdf>



Warranty



Limitations of
Fire Alarm Systems



Speakers Only:
Assembly Information