

Important: Retain these instructions

These instructions shall be used by trained service personnel only. If the equipment is used in a manner not specified by these instructions, the protection provided by the equipment may be impaired.

<https://partners.trendcontrols.com>



CONTENTS

1	Box Contents	1	3	Cleaning and Maintenance	4
2	Installation	1	4	Disposal	4

1 BOX CONTENTS

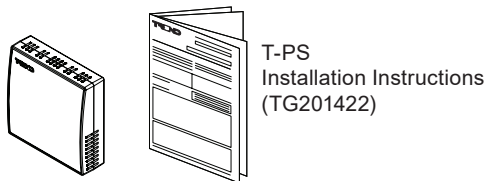

2 INSTALLATION

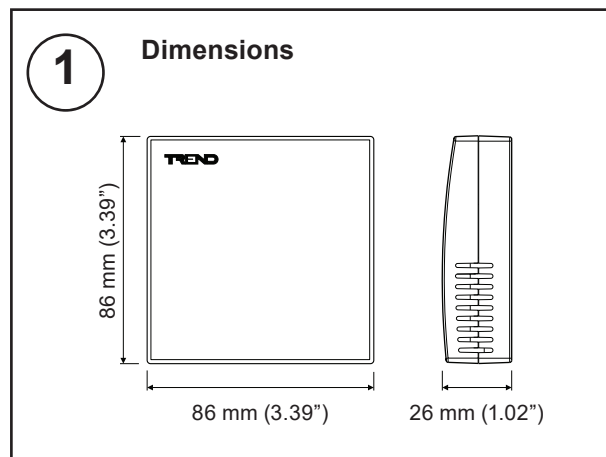

It is recommended that the installation should comply with the local electrical safety installation practices (e.g. HSE Memorandum of Guidance on Electricity at Work Regulations 1989, USA National Electric Code).

ATTENTION: Observe precautions for handling electrostatic sensitive devices.

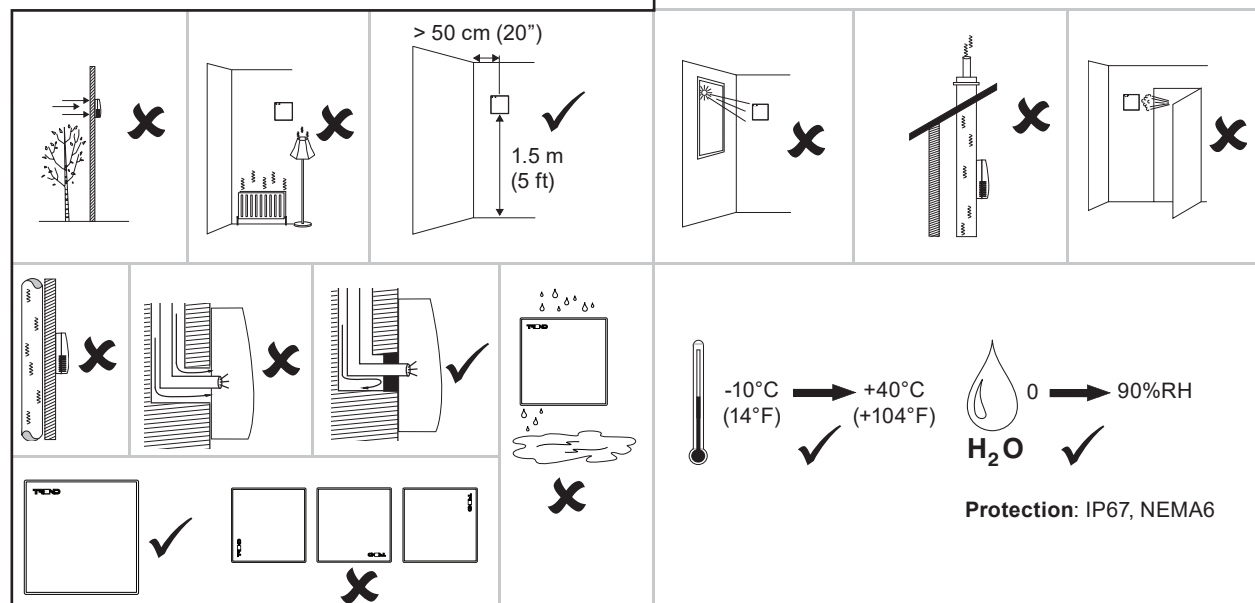
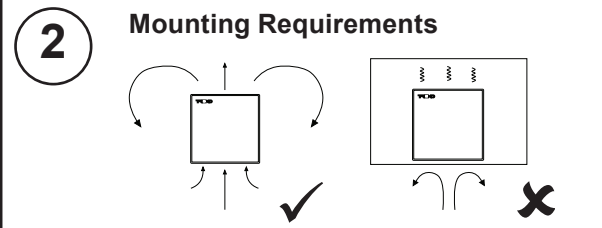

2 INSTALLATION (continued)

3

Mount Backplate

Orient the plate with the logo in this position

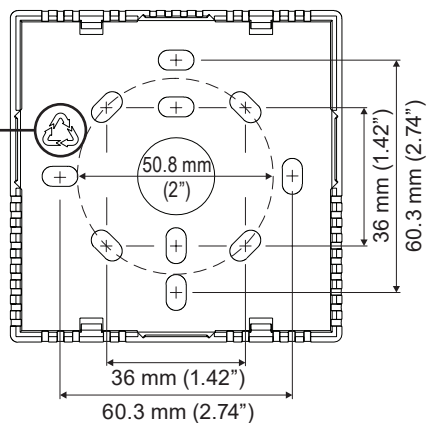

Either: directly to wall

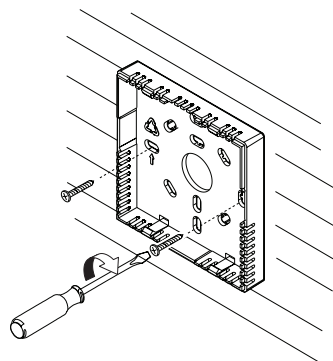

Or: to a single-gang wall box

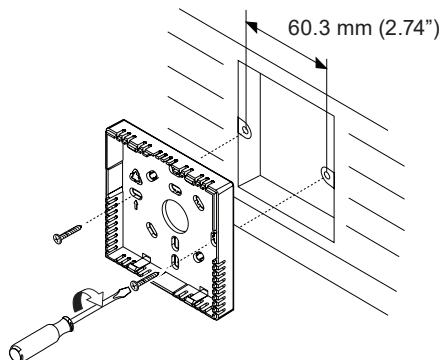

Or: to a BESA conduit box

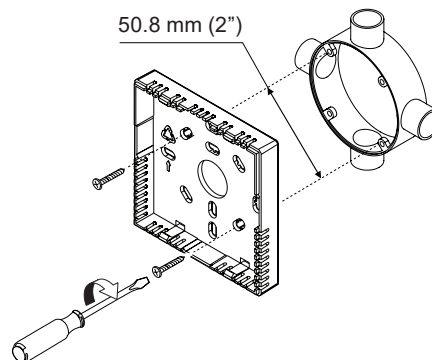

5

Route Cable (as required)

Recommended Cable: Trend TP/I/22/HF/200 (Belden 8761)

Cable entry from the rear:

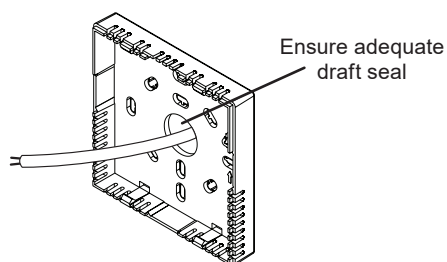

Cable entry from the top, bottom or sides:

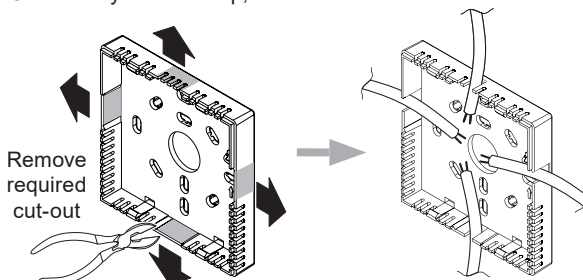

2 INSTALLATION (continued)

6

Connect to Controller

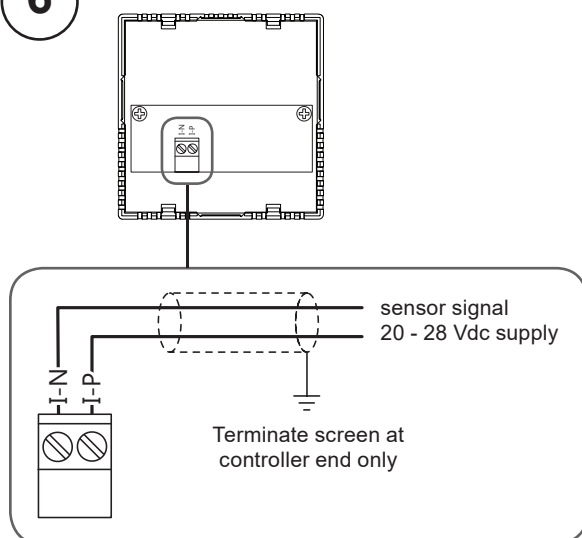

Terminal size: 0.5 to 2.5 mm² (14 to 20 AWG)

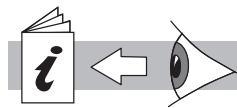

Refer to controller installation instructions for details of input type and required connections.

7

Assemble Unit

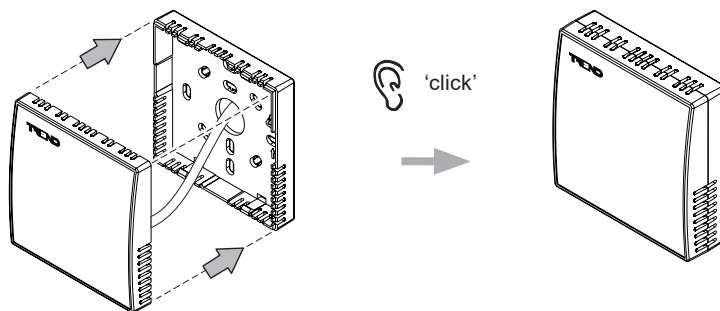

8

Configure Controller

Use IQSET to configure the Sensor Type and External Sensor strategy modules as required.

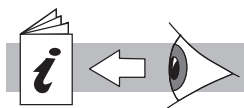

IQSET Manual (TE200147)
IQ4 Configuration Manual (TE201263)
IQ3 Configuration Manual (TE200768)
IQ Configuration Manual (90-1533)
IQeco Configuration Manual (TE201089)

Setting the Sensor Type

For the following controller types:

IQ4 series,
IQ3 series,
IQ2 series (with firmware version 2.1 or greater)

configure the Sensor Type by selecting one of the following Unique Sensor References:

PRT I -10+110 (for systems using °C)
PRT I +14+230 F (for systems using °F)

Alternatively set scaling mode to 5 (characterise) and enter scaling parameters manually as defined in the following table.

Units		°C	°F
Y	Input type	2 (current)	
E	Exponent	3	
U	Upper	40	104
L	Lower	-10	14
P	Points	2	
x	Ix	Ox	
1	4	-10	14
2	20	40	104

Note: For IQ3/4 the scaling mode and exponent (E) do not need to be set up.

2 INSTALLATION (continued)

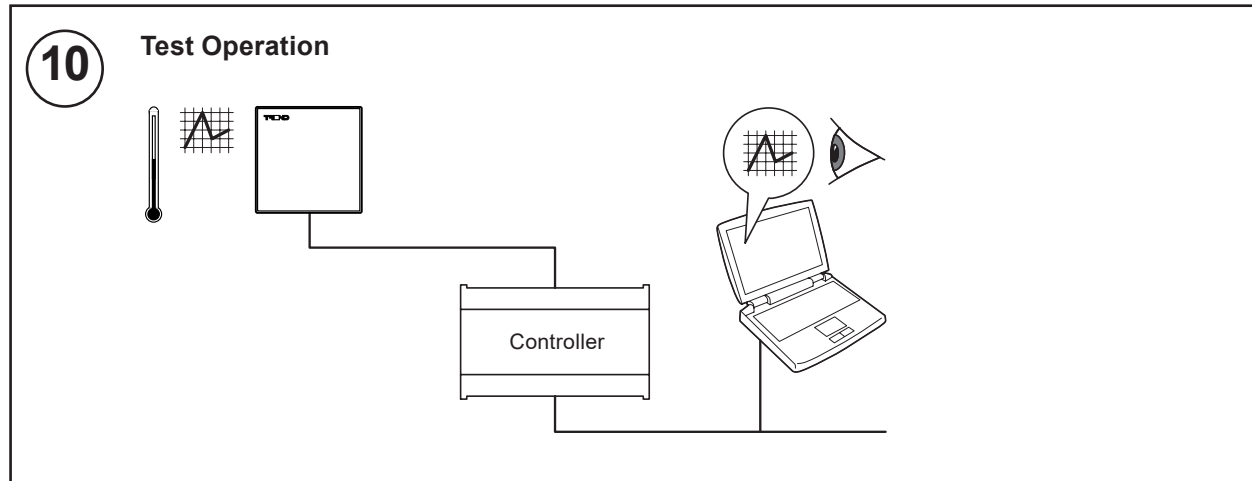

3 CLEANING AND MAINTENANCE

There are no serviceable parts inside the unit. Cleaning of the unit should be carried out in order to avoid buildup of dust or other contaminants. Disconnect power before carrying out any cleaning.

4 DISPOSAL



WEEE Directive:
At the end of their useful life the packaging and product should be disposed of by a suitable recycling centre.

Do not dispose of with normal household waste.
Do not burn.

Please send any comments about this or any other Trend technical publication to techpubs@trendcontrols.com

© 2018 Honeywell Technologies Sàrl, E&ES Division. All rights reserved. Manufactured for and on behalf of the Environmental & Energy Solutions Division of Honeywell Technologies Sàrl, Z.A. La Pièce, 16, 1180 Rolle, Switzerland by its Authorized Representative, Trend Control Systems Limited.

Trend Control Systems Limited reserves the right to revise this publication from time to time and make changes to the content hereof without obligation to notify any person of such revisions or changes.

Trend Control Systems Limited

St. Mark's Court, North Street, Horsham, West Sussex, RH12 1BW, UK. Tel: +44 (0)1403 211888, www.trendcontrols.com



TR CU Certification