

WALK TESTING

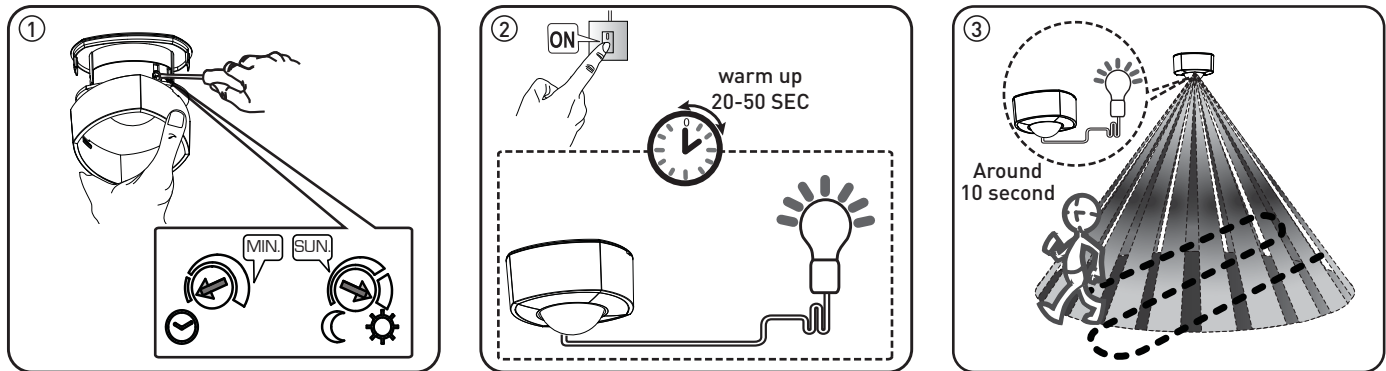

MANUAL OVERRIDE OPERATION

Activate Manual Override Operation

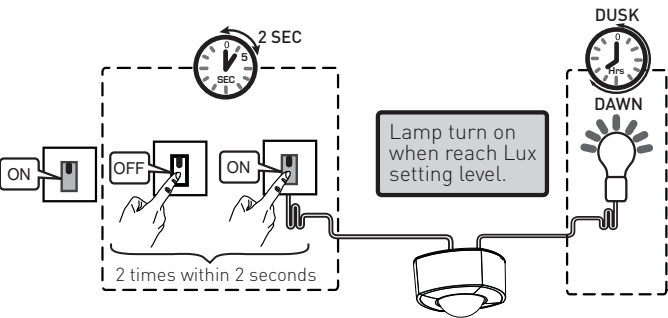

Deactivate Manual Override Operation

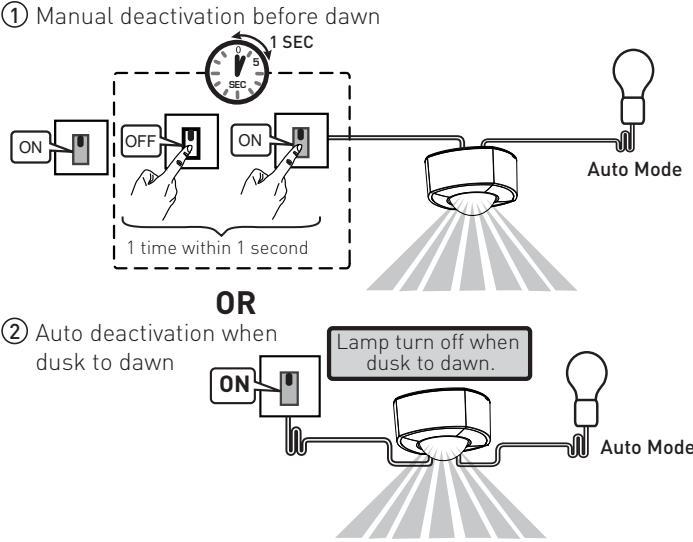

SWITCHABLE LOAD

	Max 2000W		Max 120W
	Max 500W		Max 110W
	Max 400W		Max 75W

TECHNICAL SPECIFICATIONS

Detection Range:	Up to 6 metres diameter (3m Radius) at mounting height of 2.5m
Detection Angle:	360°
Power Supply:	220 ~ 240 VAC / 50 Hz
Maximum Switchable Load:	Max load current 6A Incandescent / Halogen Max 2000W Flourescent lamp (magnetic) Max 500W Flourescent lamp (electronic ballast) Max 400W LED lamp Max 110W Fan Max 75W
Time On Adjustment:	5 seconds - 15 minutes
Dusk Level Adjustment:	Day & night or night only operation
Operating temperature:	-20 to 40°C
Environment Protection:	For ceiling mount - IP44 For flush mount - IP44 (at sensor portion only) - IP20 (ceiling board onwards)



Haydock Lane
Haydock
Merseyside
WA11 9UJ
UK
www.ex-or.com

Technical Support
+44 (0)1942 719229



LS1000R LightSpot 360° Dual Mount PIR installation and operating instructions



Only suitably qualified personnel should install this equipment

PACK CONTENTS

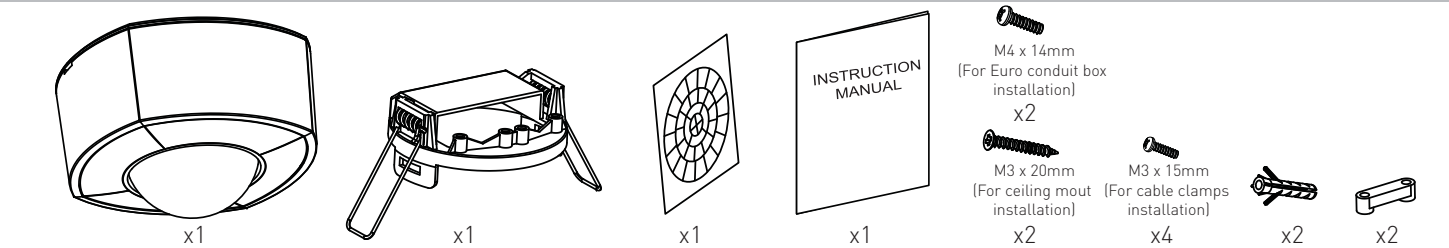

REQUIRED

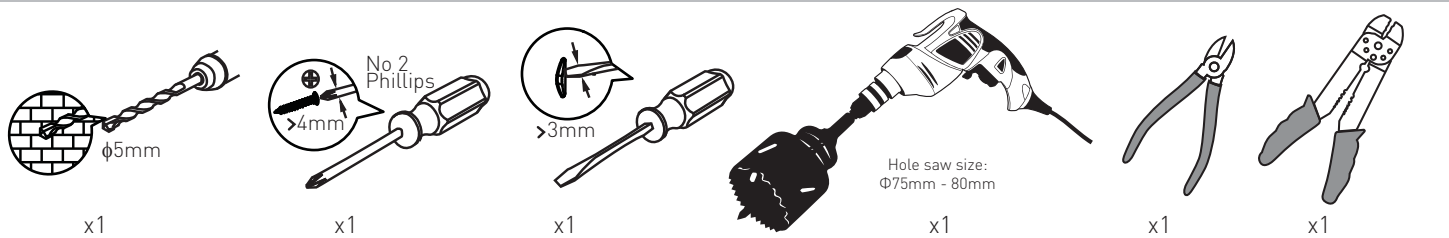

MOUNTING/ INSTALLATION STEPS

Surface Mount

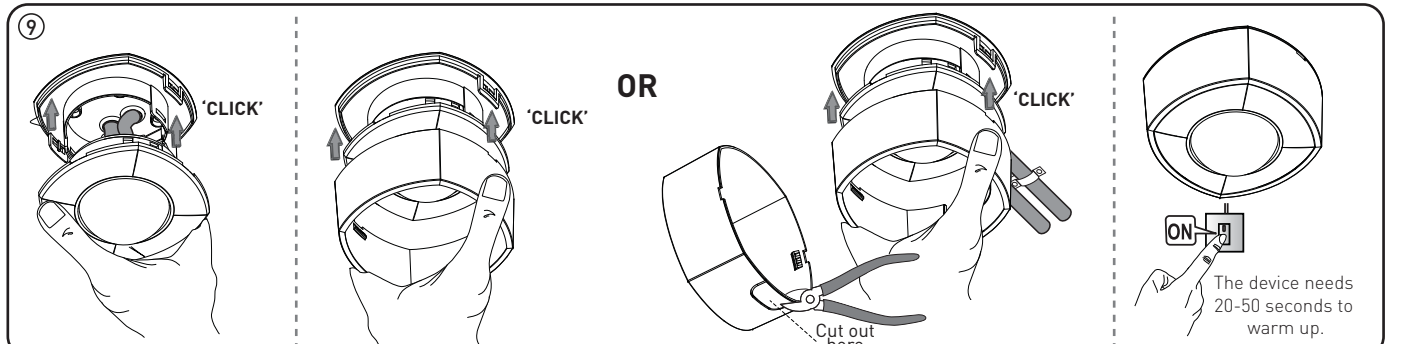
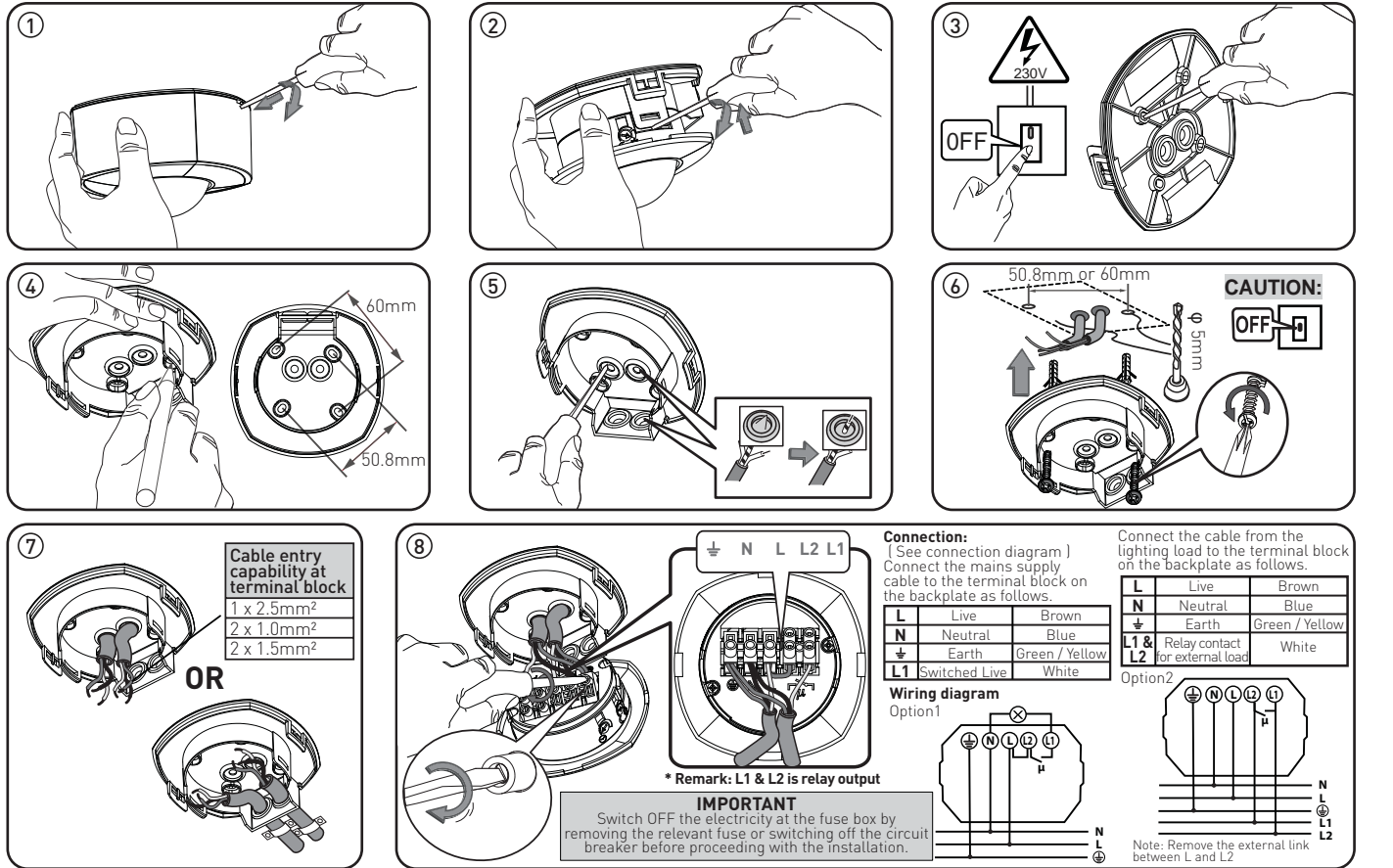

MOUNTING/ INSTALLATION STEPS

Flush Mount

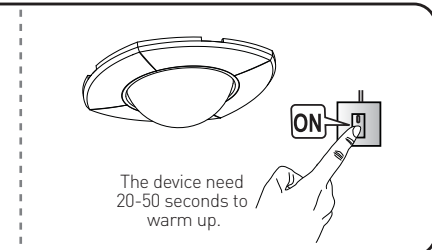
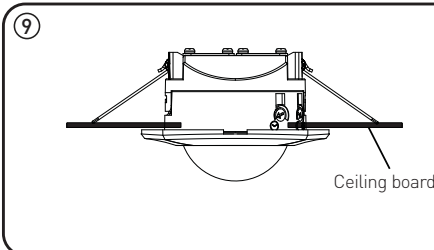
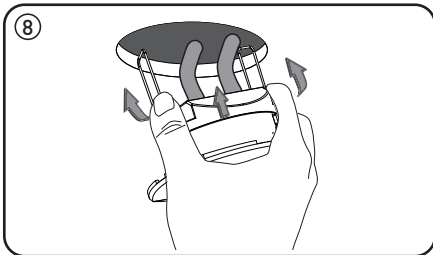
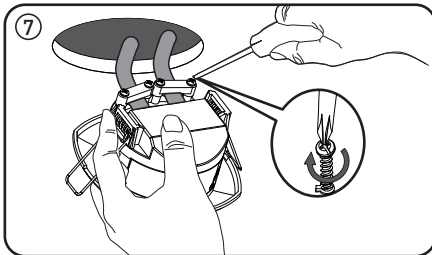
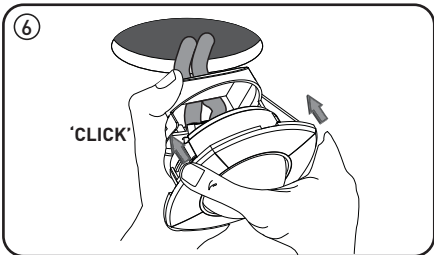
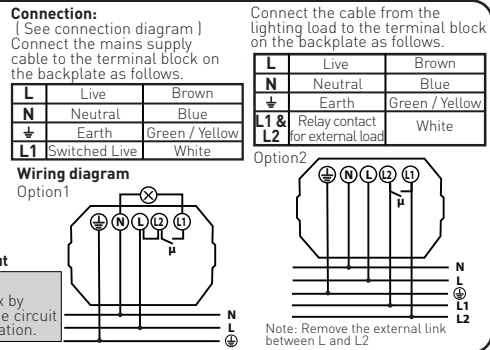
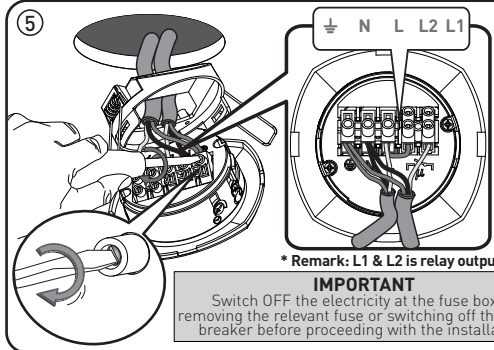
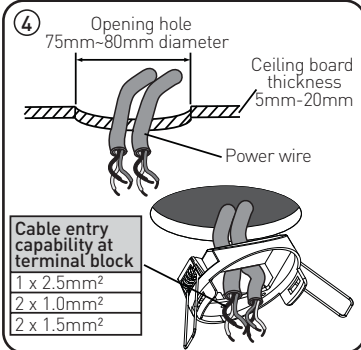
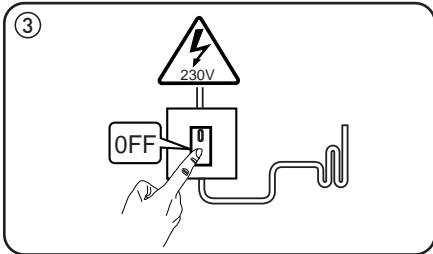
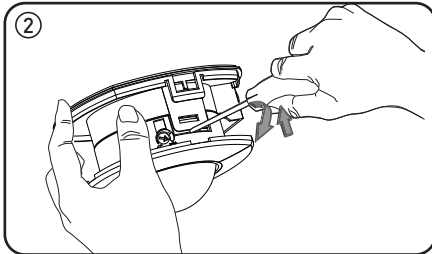
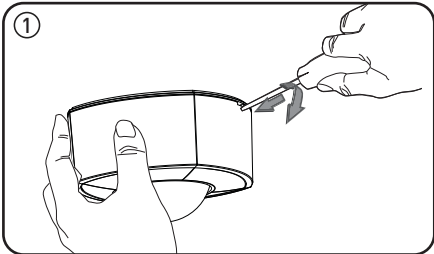

REMOVING

Surface Mount

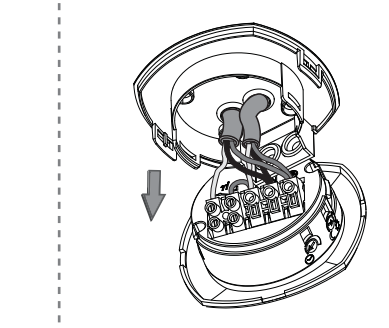
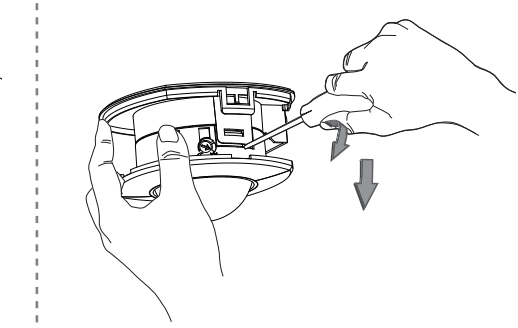
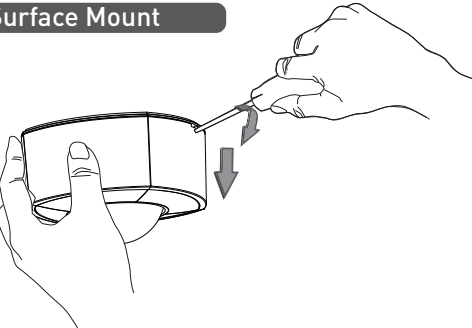

REMOVING

Flush Mount

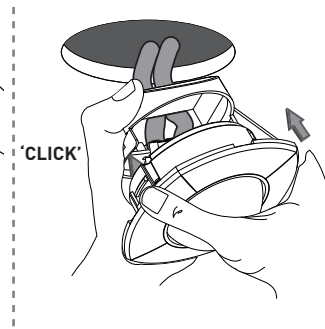
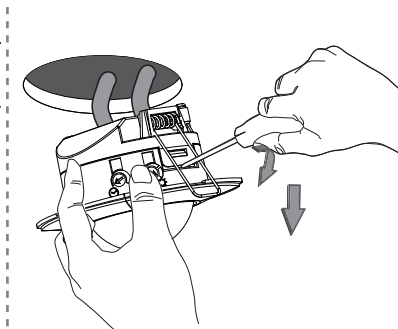
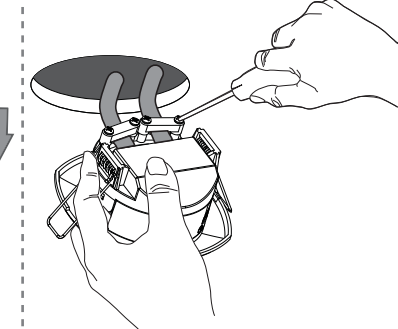
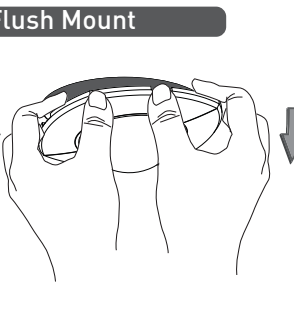

MOTION SENSOR DETECTION

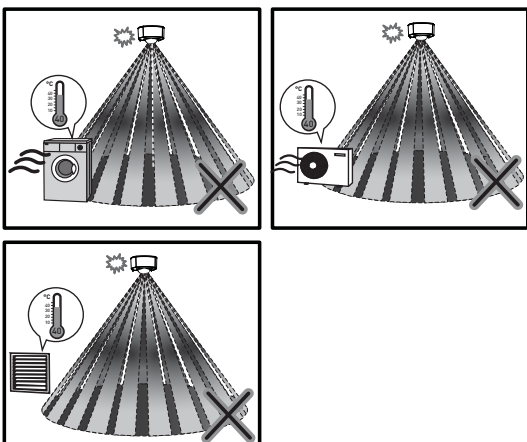
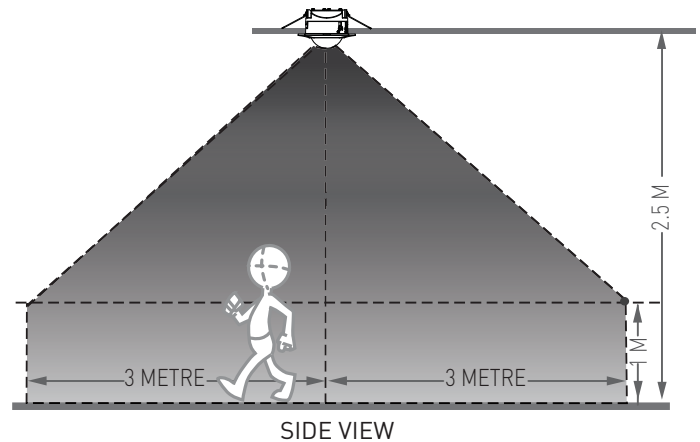
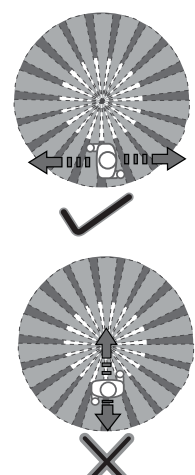
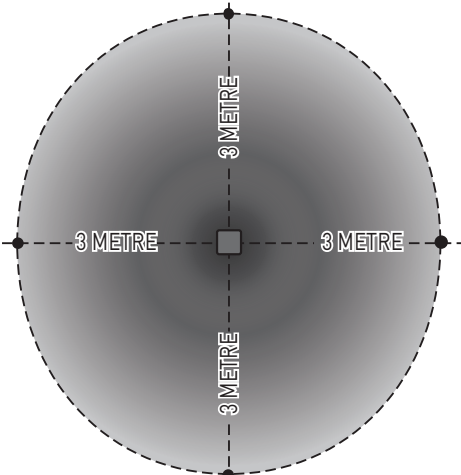
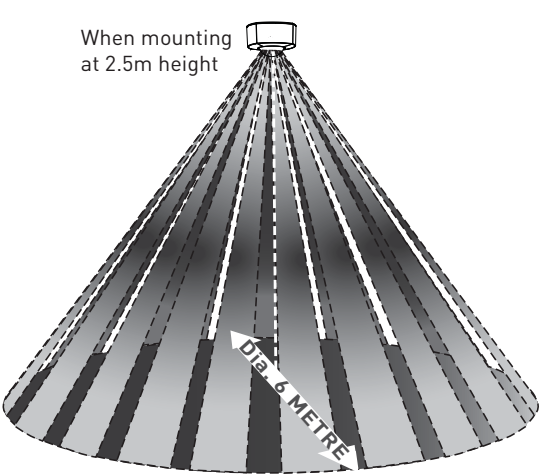

LENS MASK

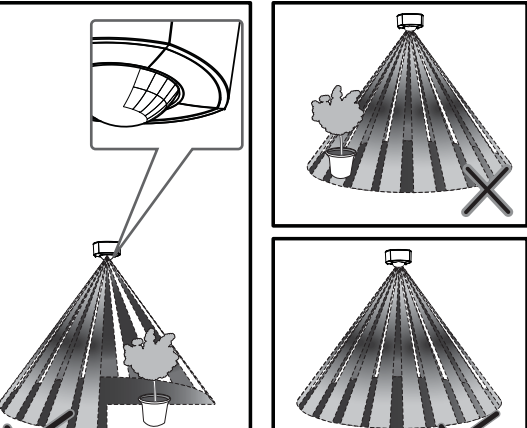
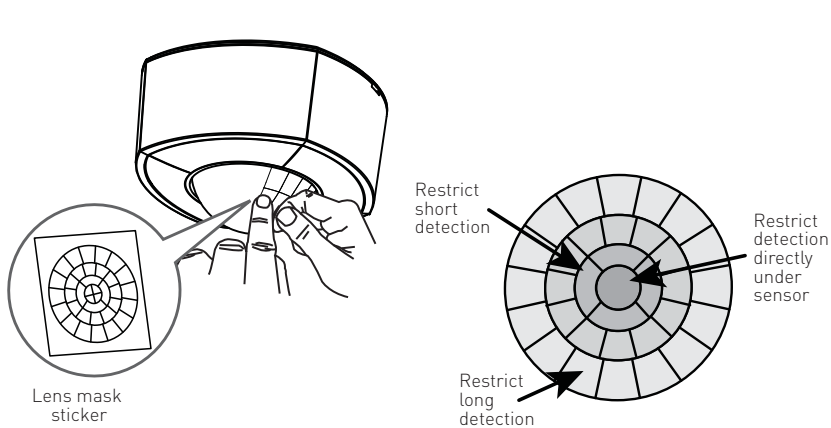

TESTING & OPERATION

Adjustment

-Can be adjusted by flat head screwdriver.

