

Space CO2, Humidity and Temperature Sensors

Important: Retain these instructions

These instructions shall be used by trained service personnel only. If the equipment is used in a manner not specified by these instructions, the protection provided by the equipment may be impaired.

<https://partners.trendcontrols.com>



CONTENTS

1	Bag Contents	1	3.2	Installation - Configuring	4
2	Storing	1	4	Cleaning and Maintenance	4
3	Installation	1	5	Disposal	4
3.1	Installation - Mounting	1			

1 BAG CONTENTS

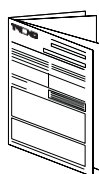
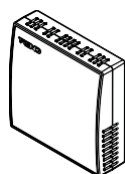

CO2/T/S, CO2/T/H/S
Installation Instructions
(TG201171)

2 STORING



-25°C
(-13°F) → +60°C
(+140°F)



0 → 90%RH



3 INSTALLATION

3.1 Installation - Mounting

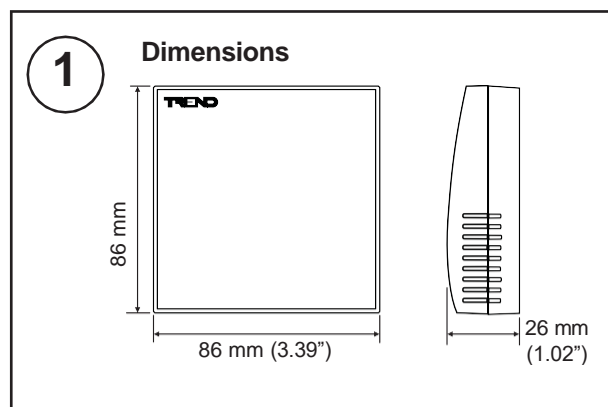

It is recommended that the installation should comply with the local electrical safety installation practices (e.g. HSE Memorandum of Guidance on Electricity at Work Regulations 1989, USA National Electric Code).

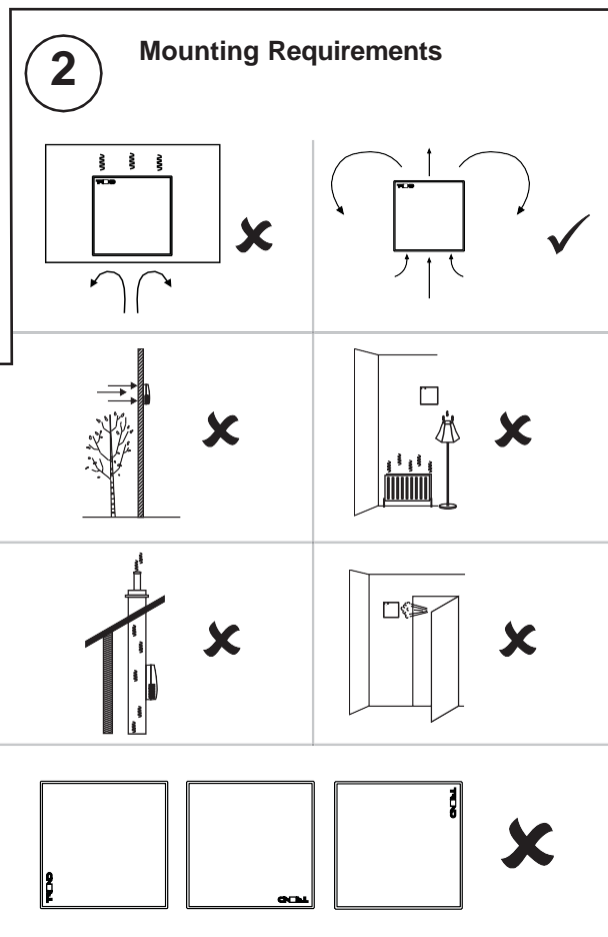
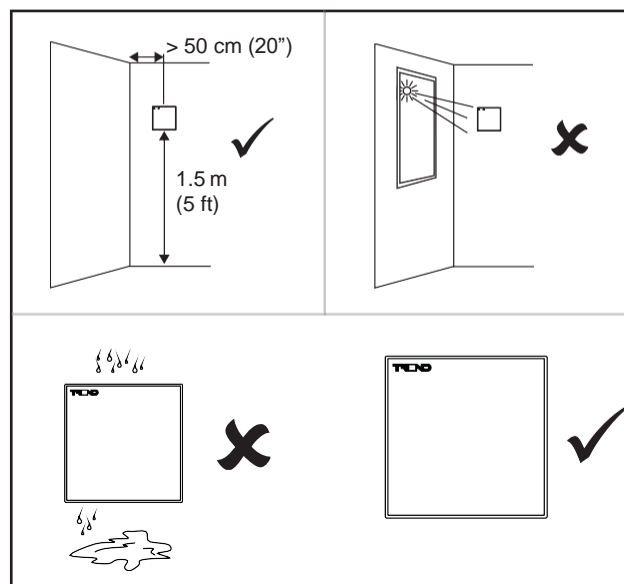

3.1 Installation - Mounting (continued)

2 Requirements (continued)

-20 °C (-4 °F) to +60 °C (+140 °F)
 0 °C (32 °F) to +40 °C (104 °F) measurement ✓
 0 %RH to 100 %RH non-condensing ✓
 H₂O

3 Remove Backplate

4 Mounting Backplate

Do not use this hole

wall box 60 mm (2.36")
 back box (BESA) 35 mm (1.38")
 wall 35 mm (1.38")

5 Remove cut out(s) (as required)

6 Route cable(s)

3.1 Installation - Mounting (continued)

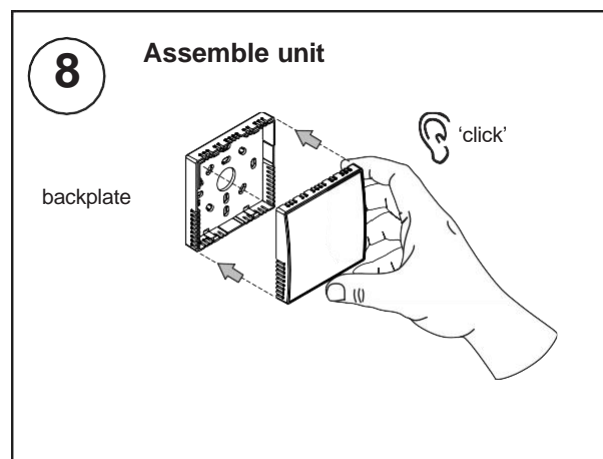
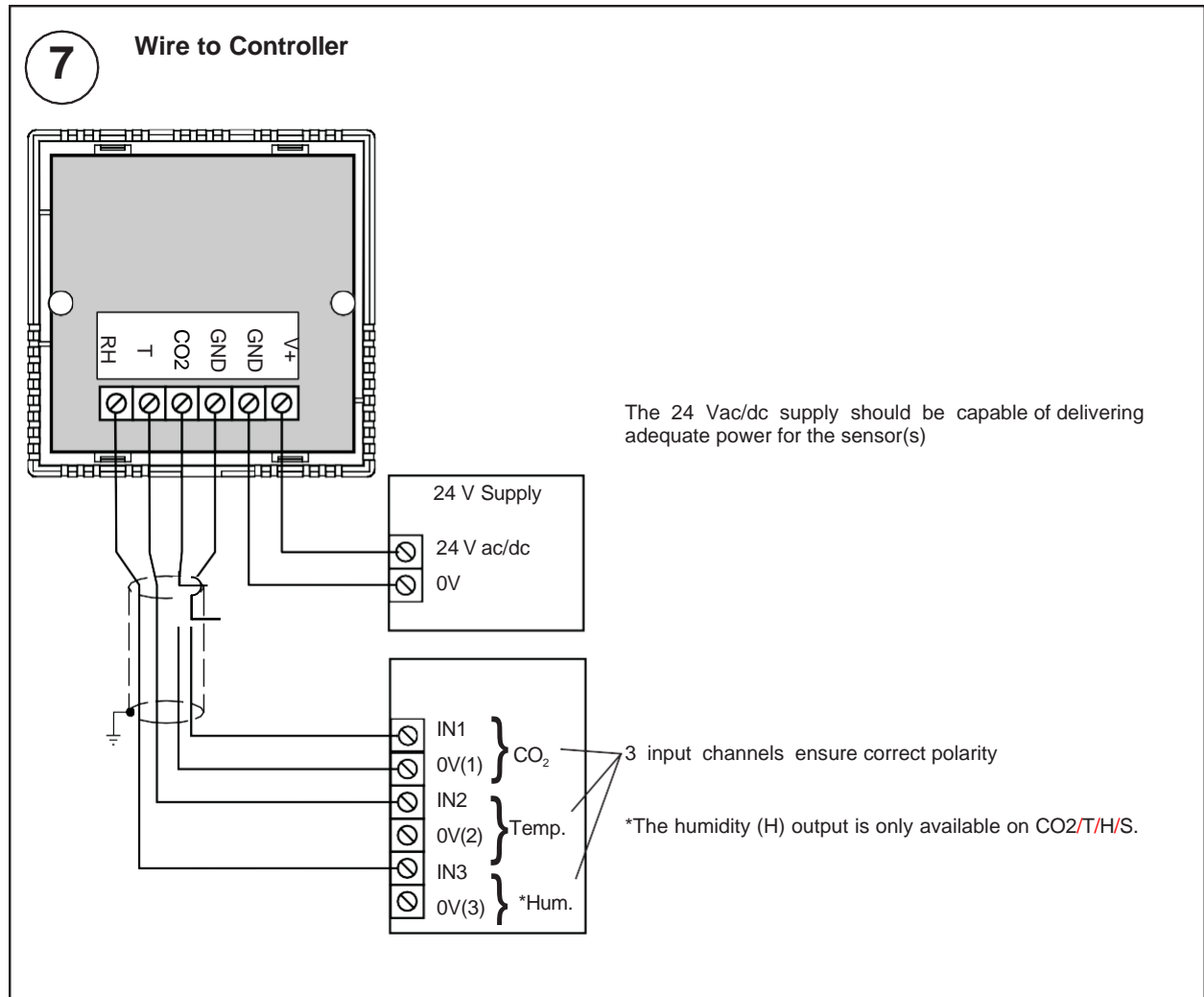

Rough handling and shipping can reduce the accuracy of the sensor.
Full accuracy is restored after the device is powered up for 250 hours non-stop.

3.2 Installation - Configuring

10

Set up IQ Sensor Types

Use SET to setup the sensor type module to use the appropriate 'Unique Sensor Reference'.

Carbon dioxide concentration:

0 to 10 V for 0 to 2000 ppm

Humidity:

(/H/ option only)

0 to 10 V for 0 to 100 %RH. Measurement range 0 to 95 %RH

Temperature:

0 to 10 V for 0 to +40 °C (32 to 104 °F)

4 CLEANING AND MAINTENANCE

Over time, the sensing element may become covered in dust. The dust can be removed using compressed air. Under no circumstances should water or cleansing agents be used on the sensing elements.

5 DISPOSAL



WEEE Directive:

At the end of their useful life the packaging, product, and battery (if fitted) should be disposed of by a suitable recycling centre.

Do not dispose of with normal household waste.

Do not burn.

Please send any comments about this or any other Trend technical publication to techpubs@trendcontrols.com



© 2022 Honeywell Products and Solutions SARL, Connected Building Division. All rights reserved. Manufactured for and on behalf of the Connected Building Division of Honeywell Products and Solutions SARL, Z.A. La Pièce, 16, 1180 Rolle, Switzerland by its Authorized Representative, Trend Control Systems Limited.

Trend Control Systems Limited reserves the right to revise this publication from time to time and make changes to the content hereof without obligation to notify any person of such revisions or changes.

Trend Control Systems Limited

St. Mark's Court, North Street, Horsham, West Sussex, RH12 1BW, UK. Tel: +44 (0)1403 211888, www.trendcontrols.com