

HONEYWELL **AMERICAN METER** **COMPANY** **SERIES 3000**



Installation Instructions

General Arrangements

Repair Parts Lists

Maintenance Instructions

For: 1-1/4", 1-1/2", 2", 3" & 4" Series 3000 Regulators

Series 3000 Industrial Regulator

General Information:

- Available Models – Standard regulator (Model 3000)
– Monitor Regulator (Model 3010)
- Available Sizes – 1-1/4", 1-1/2" – screwed connections
– 2" screwed, 2" ANSI 125 lb. flange
– 3" and 4" ANSI 125 lb. flange
- Maximum Inlet Pressure – 30 PSIG
- Outlet Pressure Range – 2" W.C. to 56" W.C.

Preparation

1. Install, operate, inspect, and maintain the regulator as outlined in these instructions and in accordance with your company's policies and applicable federal, state and local codes and laws. Installation and service to be performed by qualified personnel only.

Failure to follow these instructions may result in damage to the

Warning:

Do not connect the inlet of the regulator to a normal pressure source higher than that recommended. Never connect the regulator outlet to the source of pressure. Observe the flow direction arrow on the valve head casting.

If inlet pressure can exceed the maximum regulator outlet pressure rating, some form of overpressure protection is required to prevent possible damage to the regulator and personnel injury.

2. Check installation location for suitability. It is possible that physical changes have been made to the building site since the regulator and location were originally selected.
3. Examine regulator for shipping damage.
4. Check regulator and piping for dirt or other foreign matter which may have accumulated during shipment or handling.
5. Check data plate to determine if regulator is suitable for intended service.
6. Suitable stop valve(s) should be installed and should be conveniently located.
7. The top vent of the regulator must be unobstructed and must not be submerged in water at any time.
8. Filters are available from the manufacturer for applications where pipeline contaminants are suspected to be present.
9. Regulators may be used at temperatures between -20°F and +150°F (-30°C and 65°C).

Installation

1. Remove all shipping plugs.
2. Use good piping practice. Be sure piping and regulator are free of dirt, pipe dope and other debris. Apply pipe dope to male threads only.
3. The Series 3000 may be mounted in any position. Leave head room for removal of the diaphragm chamber to allow inspection of the valve seat. Make certain the regulator is piped up correctly with inlet pipe connection to the inlet connection and flow is in the direction as indicated by arrow located on body.
4. Turn gas on slowly. Outlet stop valves should be opened first. Do not overload the diaphragm with a sudden surge of inlet pressure.
5. Assure that there are no leaks and all connections are tight.
6. Pressure Adjustment:
 - (a) Turn gas off and depressurize the system.
 - (b) Install outlet pressure gauge. Remove seal plug, item (12), Fig. 1 for Models 1-1/4", 1-1/2", 2" and 3" only.
 - (c) Slowly turn gas on.
 - (d) Establish a low flow rate.
 - (e) Turn pressure-spring adjustment screw, on all models clockwise to increase outlet pressure or counterclockwise to decrease outlet pressure.

- (f) Establish a set pressure within the range limits of the pressure spring used.
- (g) To test for the regulator's ability to fully shut off (lock-up), shut off all flow downstream of the regulator. At lock-up, the outlet pressure will be somewhat higher than the set pressure. However, if the pressure continues to rise after three seconds, the regulator must be repaired. Observe for approximately 30 seconds.
- (h) When the set pressure has been properly adjusted and lockup tested, depressurize and remove gauges and lines.
- (i) Replace seal plug.
- (j) Pressurize – check all connections for leaks.

Warning:

INSIDE INSTALLATION requires a vent line of sufficient diameter to carry gas vented by the relief valve to a safe outside location, away from any opening in the building. Vent-piping thread size is either 3/4-, 1- or 2-inch NPT depending on model. In accordance with the American National Standard for pipe threads ANSI B2.1. Keep vent lines as short and direct as possible.

OUTSIDE INSTALLATION requires that care be taken to prevent vent opening from freezing closed or becoming blocked or permitting water to enter from any cause. Particular consideration should be given to sites where flooding, snow or freezing rain may be experienced. The vent or vent-line port should point vertically downward, and overhead protection should be used where necessary. Periodically check vent to be certain it is not obstructed

Inspection and Maintenance

Warning:

If the regulator system develops a leak or vents gas, call a qualified gas serviceman promptly.

Inspection and maintenance of the 3000 regulator has been simplified for practical reasons. Access to the regulator is gained by removing the circular clamp ring, item (17), then lifting the entire regulator (less body) out of the line. A new working unit may be substituted while the one removed is being serviced. Repair parts are offered if maintenance of the regulator is required. Normal replacement parts are the seat disc, item (57), which can become pitted and worn and the Buna-N or felt ring (21) which may collect moisture or particles of foreign matter.

Lock-up tests should be conducted periodically to check the valve seat disc and valve cage sealing surface condition. Inspection of the valve seat disc and valve cage may be performed in the field. Follow the instructions below. Care should be exercised to prevent foreign matter from entering the regulator.

Procedure for inspection and replacement of the valve seat disc and/or valve cage:

1. Shut off gas supply and depressurize the regulator system.
2. Remove the clamp ring, item (17), by loosening the clamp tension nut just enough to slip the ring over the joint. Let the ring rest on the regulator body.
3. Lift the diaphragm chamber and valve assembly vertically from the body. Visually inspect the seating edge of the valve cage, item (19) and the valve seat disc, item (57). Replace if damaged.
4. To remove the seat disc and/or cage, grip the valve stem, item (18), with an open-end wrench and remove the retaining nut (26), valve stem flapper (25) and balancing piston (20). When reassembling the valve cage and valve seat, make certain the balancing piston is centered on the shoulder under the seat disc retainer (22). When tightening the retaining nut, be careful not to distort the valve stem flapper.
5. Apply silicone grease sparingly to the O-ring (56) at the bottom of the valve cage. Assemble the diaphragm chamber to the regulator body, keeping the chamber vertical and allowing its own weight to seat the assembly. Do not rotate the chamber as this may distort the secondary diaphragm (15). Center clamp ring over body joint and tighten clamp tension nut.

Series 3000 Industrial Regulator

Replacing the Pressure Spring

1-1/4" to 3" Models:

1. Shut off the gas supply and depressurize the regulator system. Remove the seal plug (2).
2. Unscrew pressure-adjusting screw (4) with a screwdriver and remove the pressure-adjusting screw completely.
3. Remove the pressure spring (52) and install a new pressure spring, centering the lower end of the spring in the spring guide (6).
4. Replace the pressure-adjusting screw and turn adjusting screw to about mid-position.
5. Adjust the outlet set pressure as described above and replace the seal plug.

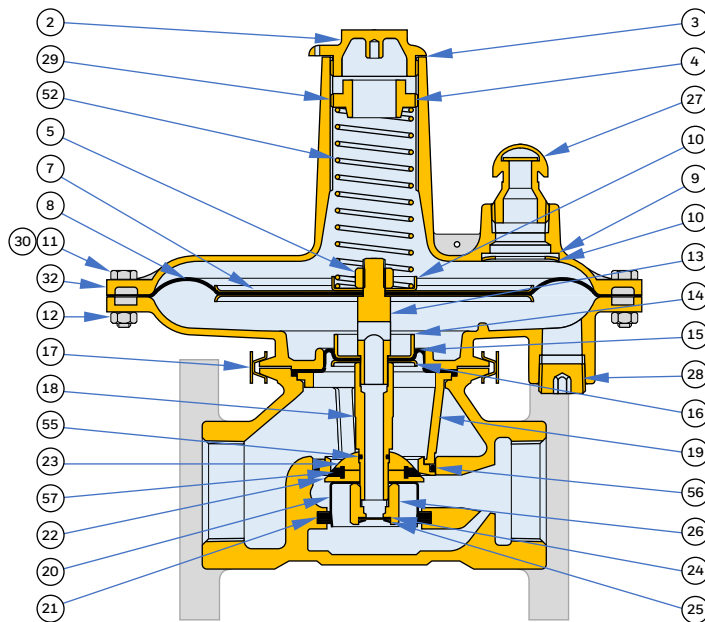
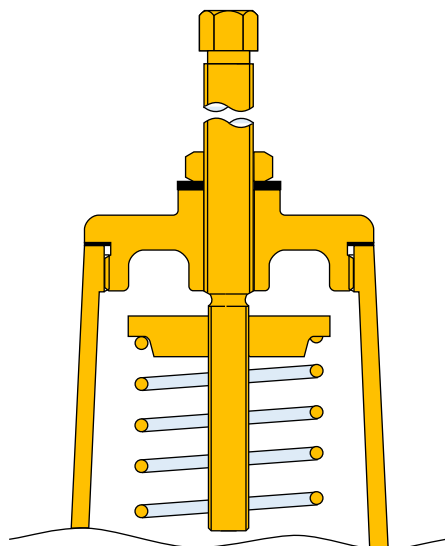

Figure 1



4" Model Only
Pressure Spring Replacement

Replacing the Pressure Spring 4" Model Only

1. To remove seal plug, first loosen adjusting-screw lock nut, completely back off adjusting screw and then turn down approximately 1/8" (two turns).
Remove seal plug. Hold adjusting screw to prevent rotation while unscrewing seal plug. Replace pressure spring with lower end centered in spring guide.
2. To install seal plug assembly, position spring follower approximately 1/8" (two turns) from shoulder on adjusting screw. Engage slot of spring follower with inner rib in regulator top and hold spring follower up against underside of threads in top while engaging seal plug. Hold adjusting screw to prevent rotation while screwing seal plug into position.

CAUTION

Regulators that have a pressure spring removed or replaced must have their set pressure established. If the pressure spring is different from that shown on the data plate, mark spring range on the regulator or on its tag and cross out the old value.

Replacing the Diaphragm

1. To replace the diaphragm assembly, first remove the spring then the complete diaphragm chamber and valve assembly. Then remove the flange bolts (11) and lift off the upper diaphragm chamber (32). Remove the pressure spring. Grip the valve stem (13) with an open-end wrench and remove the diaphragm stem nut (5), spring guide, upper diaphragm plate (7) and the diaphragm (8). Do not remove the lower diaphragm plate (7).
2. Install the new diaphragm, the top diaphragm plate, spring guide and stem nut, being careful to align the diaphragm bolt holes with those in the body.
3. Place the upper diaphragm chamber over the diaphragm, with the vent in the proper position and install the bolts. Take care to prevent folds in the diaphragm between flanges. Install the range spring and adjusting screw.
4. Apply silicone grease sparingly to the O-ring at the bottom of valve cage and assemble the diaphragm chamber to the regulator body as previously described.
5. Adjust the outlet set pressure as described above and replace seal plug.

Replacing the Felt Ring (2", 3", 4" sizes)

1. Remove the diaphragm chamber and valve-cage assembly.
2. Remove and install a new balancing-piston felt ring (21). The felt strip must be installed so that when placed in the groove, the side with the black identification stripes is facing toward the coupling-ring flange, and the joining ends should face the inlet port. Care should be taken to insure that even contact is made between the felt ring and the balancing piston throughout their circumference, including the point where the ends of the felt ring meet.

Black identification stripes (or letter "T")

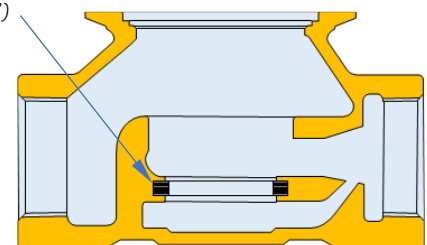

Note: When installing the Buna-N balancing piston ring in the 1-1/4" and 1-1/2" sizes, ensure that the letter T stamped on the ring faces upward.

1-1/4" and 1-1/2" Model 3000 Industrial Regulator Assembly

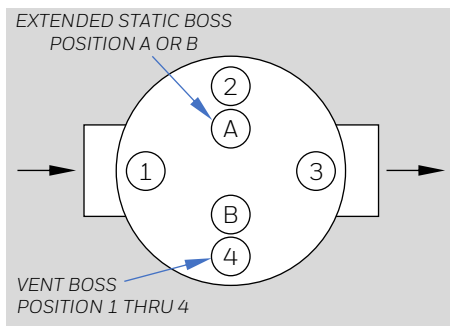

Note: Install balancing piston ring with "T" marking up. Joint can be in any position.

Regulator Assembly Positions

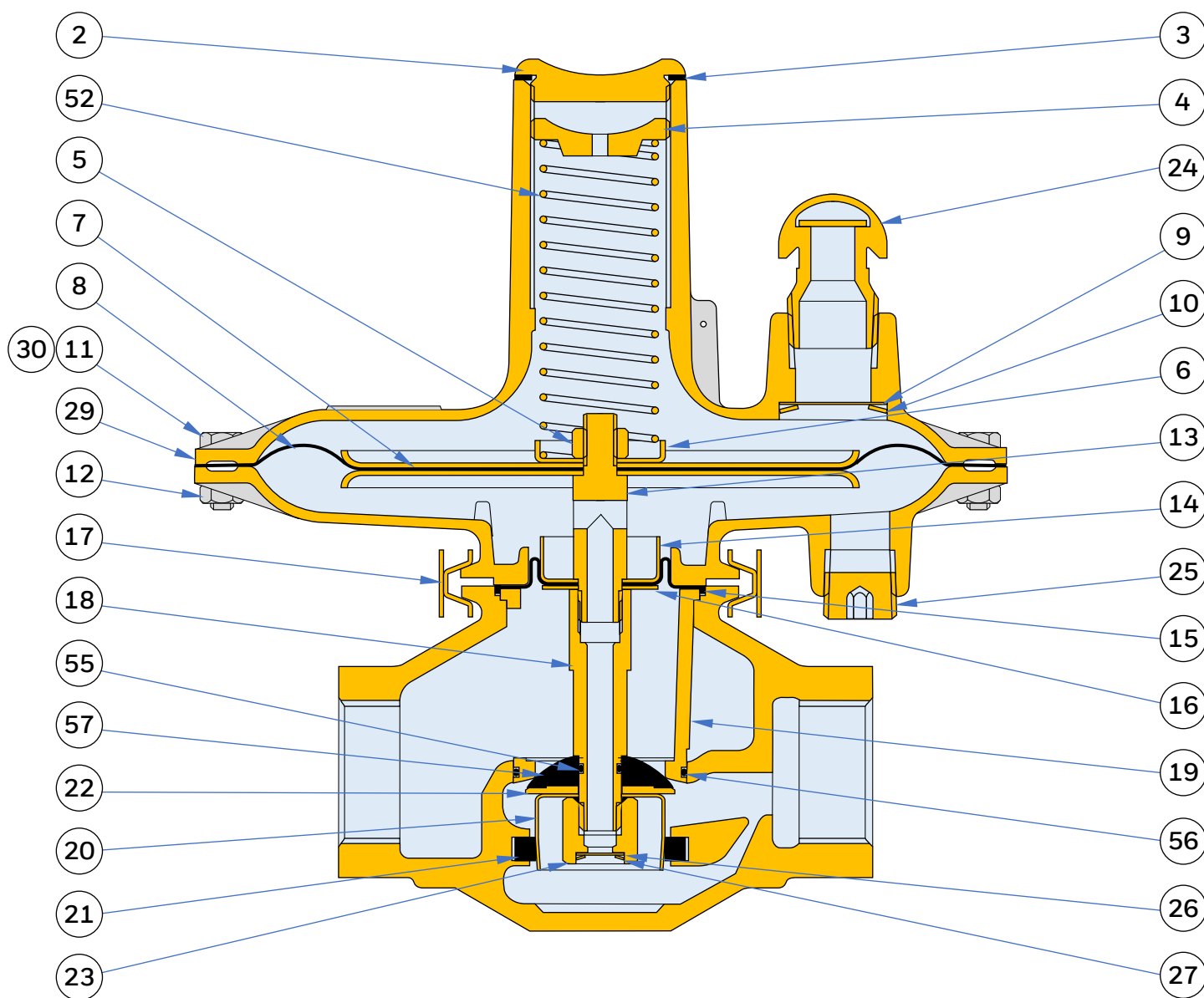

1-1/4" and 1-1/2" Model 3000 Industrial Regulator Assembly

Common Parts List

Quantity	Item#	Part Name	Part No.	Description
1	2	Seal Plug	73081P001	
1	3	Gasket (Seal Plug)	70019P098	
1	4	Pressure-Adjusting Screw	73080P001	
1	5	Diaphragm Stem Nut	78020P005	
1	6	Spring Guide	72272P004	
2	7	Diaphragm Plate	70012P057	
1	8	Diaphragm	70014P169	
1	9	Vent Flapper	72163P017	
1	10	Retaining Ring (Vent Flapper)	78074P009	
8	11	Hex-Head Cap Screw	78001P004	
8	12	Hex Nut	22032P078	
1	13	Diaphragm Stem	73029P001	
1	14	Secondary Diaphragm Plate	73031P001	Upper
1	15	Secondary Diaphragm	73034P001	
1	16	Secondary Diaphragm Plate	70176P034	Lower
1	17	Body Coupling	78134P001	
1	18	Valve Stem	73030P001	
1	19	Valve Cage	73027P001	
1	20	Balancing Piston	73032P001	
1	21	Balancing Piston Ring	74035P001	
1	22	Retainer	73033P001	Lower
1	23	Balancing Piston Ret. Nut	73288P001	
1	24	Vent Cap	78069P004	
1	25	Pipe Plug (Lower Chamber)	78039P025	3/4" NPT
1	26	Valve-Stem Flapper	72163P013	
1	27	Ret. Ring (Vent-Stem Flap)	78074P013	
1	28	Tag	78071P051	
1	29	Label	78482P002	

Optional Parts List

Quantity	Item#	Part Name	Part No.	Description
1	52	Pressure Spring	70156P033	1" – 3"
			70157P034	3" – 7"
			70157P035	7" – 14"
			70157P036	14" – 28"
			70157P037	#1 – #2
1	55	O-Ring (Valve Stem)	78037P005	Buna-N (Standard)
1	56	O-Ring (Valve Cage)	78037P061	Buna-N (Standard)
			78037P081	Viton
1	57	Valve-Seat Disc Assembly	73075G001	Buna-N (Standard)
			73075G002	Viton

Standard Spare Kits

Part Name	Part No.	Description
Spare Kit	73913K001	Includes Item # 3, 21, 26, 55, 56, 57
Spare Kit	73913K002	Includes Item # 3, 8, 9, 10, 11, 12, 15, 21, 26, 27, 55, 56, 57

1-1/4" and 1-1/2" Model 3010 Industrial Regulator Assembly

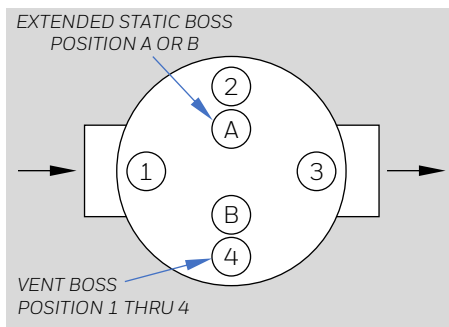

Note: Install balancing piston ring with "T" marking up. Joint can be in any position.

Regulator Assembly Positions

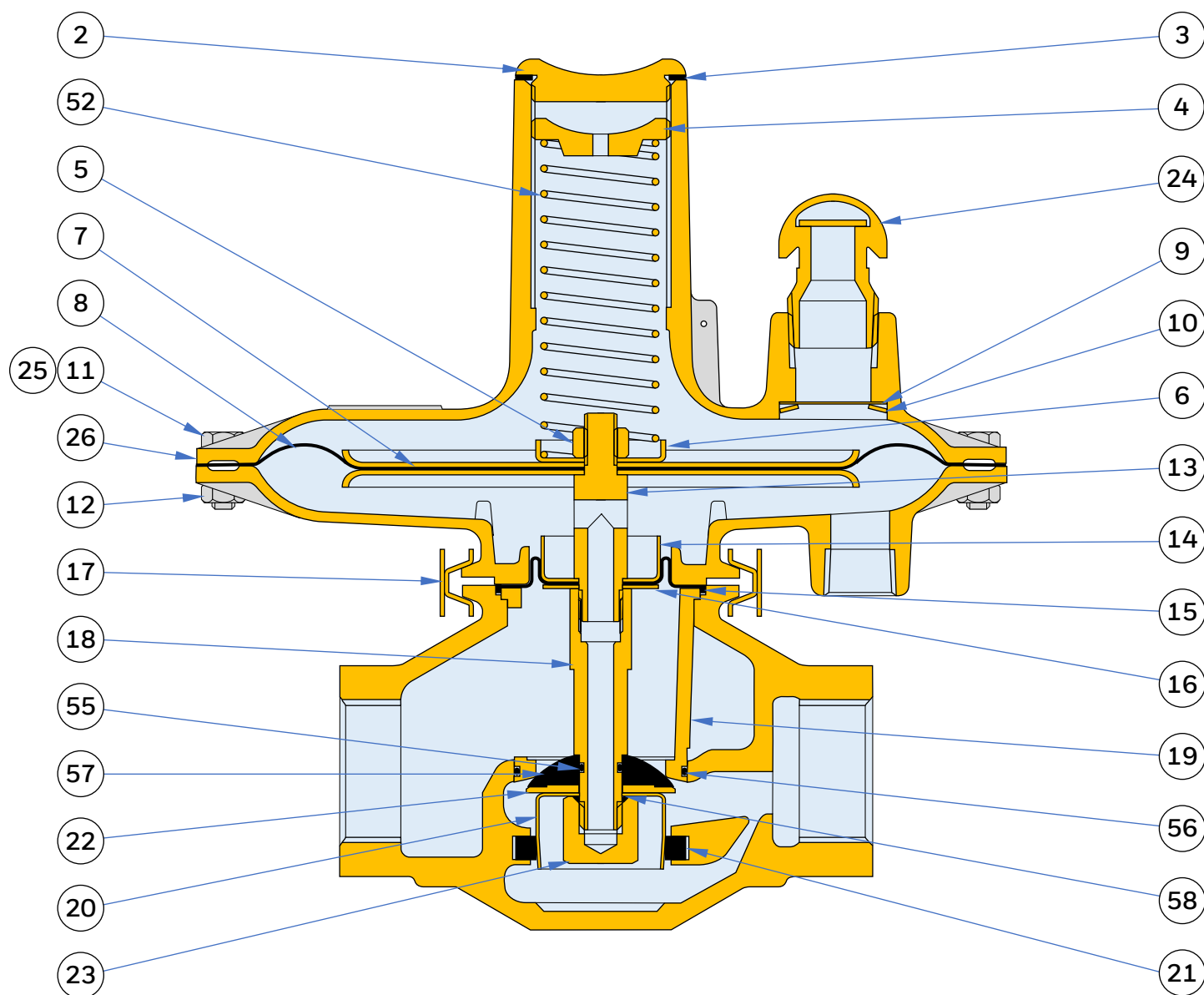

1-1/4" and 1-1/2" Model 3010 Industrial Regulator Assembly

Common Parts List

Quantity	Item#	Part Name	Part No.	Description
1	2	Seal Plug	73081P001	
1	3	Gasket (Seal Plug)	70019P098	
1	4	Pressure-Adjusting Screw	73080P001	
1	5	Diaphragm Stem Nut	78020P005	
1	6	Spring Guide	72272P004	
2	7	Diaphragm Plate	70012P057	
1	8	Diaphragm	70014P169	
1	9	Vent Flapper	72163P017	
1	10	Retaining Ring (Vent Flapper)	78074P009	
8	11	Hex-Head Cap Screw	78001P004	
8	12	Hex Nut	22032P078	
1	13	Diaphragm Stem	73029P001	
1	14	Secondary Diaphragm Plate	73031P001	Upper
1	15	Secondary Diaphragm	73034P001	
1	16	Secondary Diaphragm Plate	70176P034	Lower
1	17	Body Coupling	78134P001	
1	18	Valve Stem	73030P001	
1	19	Valve Cage	73027P001	
1	20	Balancing Piston	73032P001	
1	21	Balancing Piston Ring	74035P001	
1	22	Retainer	73033P001	Lower
1	23	Balancing Piston Ret. Nut	73288P001	
1	24	Vent Cap	78069P004	1" NPT
1	25	Tag	78071P051	
1	26	Label	78482P002	

Optional Parts List

Quantity	Item#	Part Name	Part No.	Description
1	52	Pressure Spring	70156P033	1" – 3"
			70157P034	3" – 7"
			70157P035	7" – 14"
			70157P036	14" – 28"
			70157P037	#1 – #2
1	55	O-Ring (Valve Stem)	78037P005	Buna-N (Standard)
			78037P074	Viton
1	56	O-Ring (Valve Cage)	78037P061	Buna-N (Standard)
			78037P081	Viton
1	57	Valve-Seat Disc Assembly	73075G001	Buna-N (Standard)
			73075G002	Viton
1	58	O-Ring (Piston Ret. Cap)	78037P062	Buna-N (Standard)
			78037P082	Viton

Standard Spare Kits

Part Name	Part No.	Description
Spare Kit	73913K001	Includes Item # 3, 21, 26, 55, 56, 57
Spare Kit	73913K002	Includes Item # 3, 8, 9, 10, 11, 12, 15, 21, 55, 56, 57

2" Model 3000 Industrial Regulator Assembly

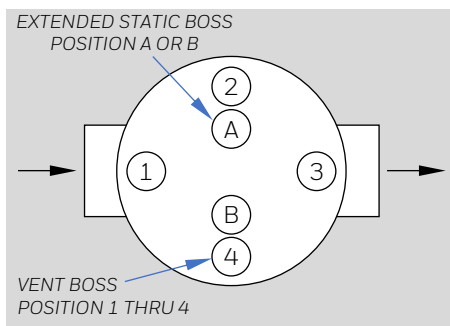

Note: Install felt ring with black stripes up. Joint to be located on valve inlet side.

Regulator Assembly Positions

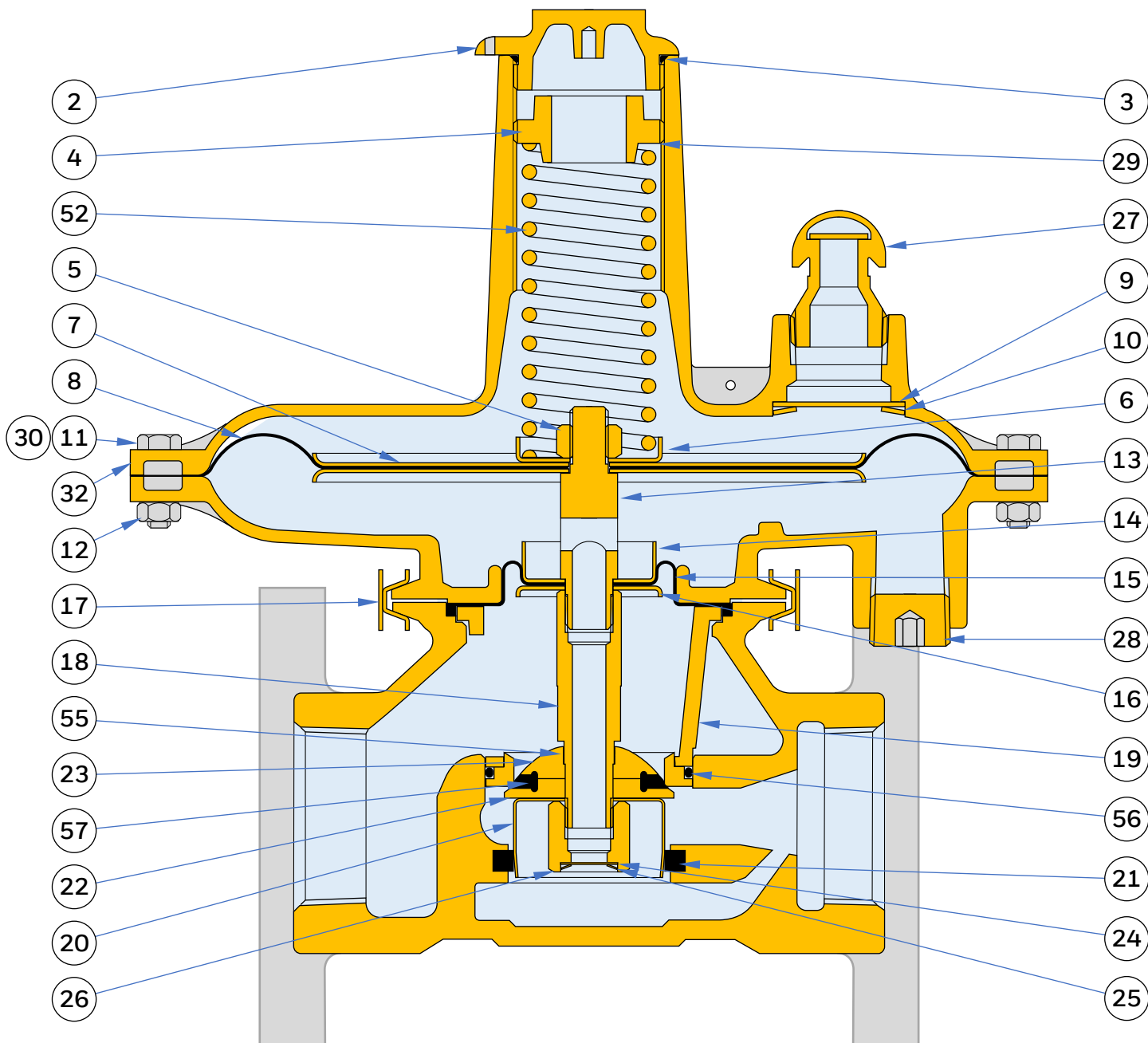

2" Model 3000 Industrial Regulator Assembly

Common Parts List

Quantity	Item#	Part Name	Part No.	Description
1	2	Seal Plug	70103P001	
1	3	O-Ring (Seal Plug)	42710P107	
1	4	Pressure-Adjusting Screw	73183P001	
1	5	Diaphragm Stem Nut	78020P008	
1	6	Spring Guide	70012P038	
2	7	Diaphragm Plate	70012P046	
1	8	Diaphragm	70014P156	
1	9	Vent Flapper	72770P002	
1	10	Retaining Ring (Vent Flapper)	92943P118	
12	11	Hex-Head Cap Screw	78001P032	
12	12	Hex Nut	78020P003	
1	13	Diaphragm Stem	72694P001	
1	14	Secondary Diaphragm Plate	72689P001	Upper
1	15	Secondary Diaphragm	72688P001	
1	16	Secondary Diaphragm Plate	70012P049	Lower
1	17	Body Coupling	78134P002	
1	18	Valve Stem	72687P001	
1	19	Valve Cage	72691P004	
1	20	Balancing Piston	72695P001	
1	21	Felt Ring	72699P001	
1	22	Seat-Disc Retainer	72959P001	Lower
1	23	Seat-Disc Retainer	72960P001	Upper
1	24	Valve-Stem Flapper	72163P011	
1	25	Ret. Ring (Valve Stem Flap)	78074P024	
1	26	Balancing Piston Ret. Nut	73286P001	
1	27	Vent Cap	78069P005	1" NPT
1	28	Pipe Plug (Lower Chamber)	78039P011	3/4" NPT
1	29	Spring Follower	73261P001	
1	30	Tag	78071P051	
1	31	Instruction Tag	73790P001	
1	32	Label	78482P002	

Optional Parts List

Quantity	Item#	Part Name	Part No.	Description
1	52	Pressure Spring	70157P025	1" – 3"
			70157P027	3" – 7"
			70157P006	7" – 14"
			70157P017	14" – 28"
			70157P024	#1 – #2
1	55	O-Ring (Valve Stem)	78037P054	Buna-N (Standard)
			78037P079	Viton
1	56	O-Ring (Valve Cage)	78037P040	Buna-N (Standard)
			78037P076	Viton
1	57	Valve-Seat Disc	72696P001	Buna-N (Standard)
			72696P002	Viton

Standard Spare Kits

Part Name	Part No.	Description
Spare Kit	73913K003	Includes Item # 3, 21, 24, 55, 56, 57
Spare Kit	73913K004	Includes Item # 3, 8, 9, 10, 11, 12, 15, 21, 24, 25, 55, 56, 57

2" Model 3010 Industrial Regulator Assembly

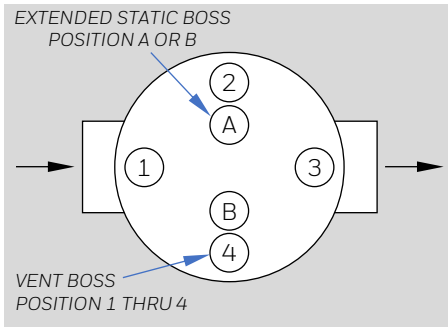

Note: Install felt ring with black stripes up. Joint to be located on valve inlet side.

Regulator Assembly Positions

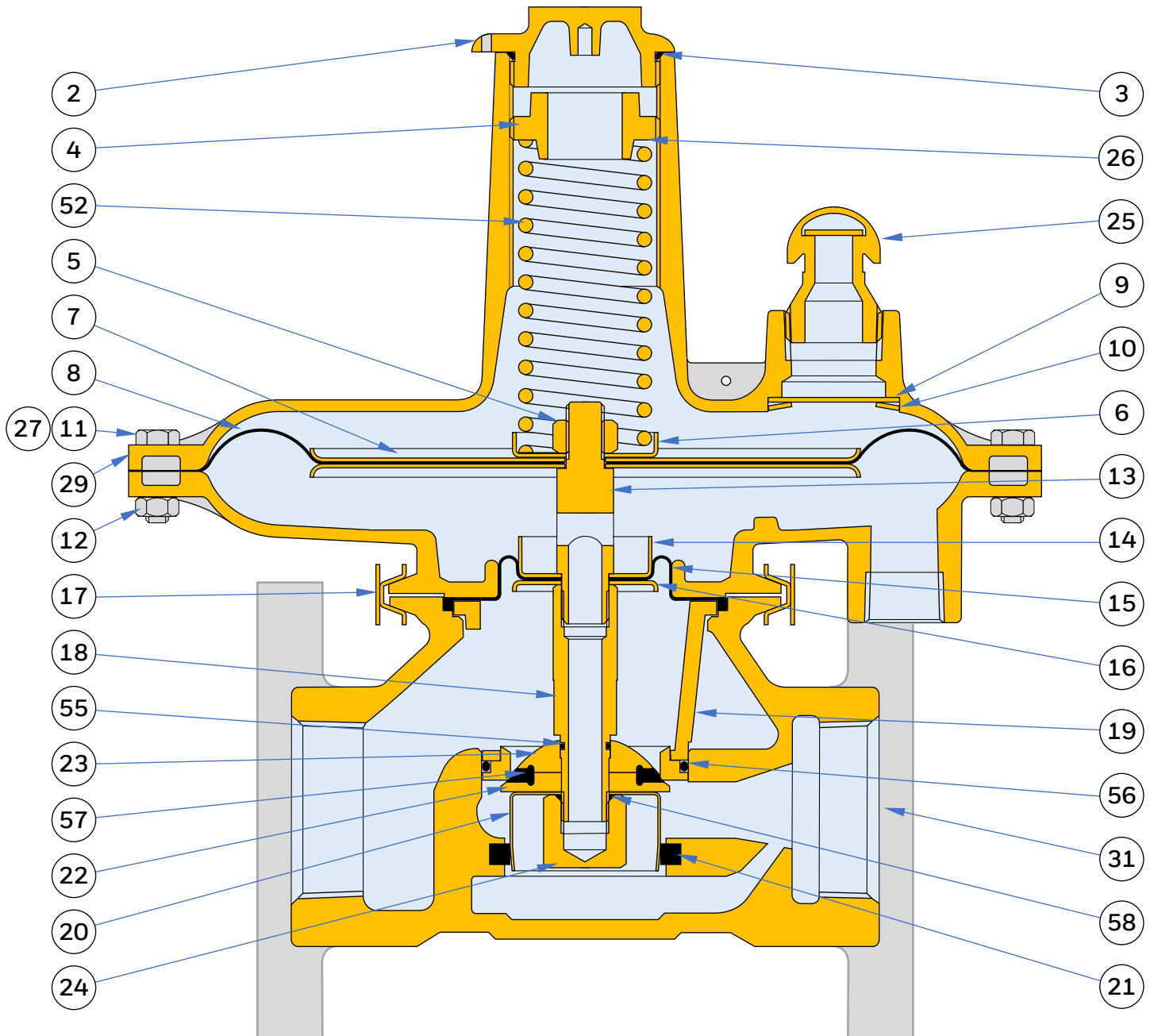

2" Model 3010 Industrial Regulator Assembly

Common Parts List

Quantity	Item#	Part Name	Part No.	Description
1	2	Seal Plug	70103P001	
1	3	O-Ring (Seal Plug)	42710P107	
1	4	Pressure-Adjusting Screw	73183P001	
1	5	Diaphragm Stem Nut	78020P008	
1	6	Spring Guide	70012P038	
2	7	Diaphragm Plate	70012P046	
1	8	Diaphragm	70014P156	
1	9	Vent Flapper	72770P002	
1	10	Retaining Ring (Vent Flapper)	92943P118	
12	11	Hex Head Cap Screw	78001P032	
12	12	Hex Nut	78020P003	
1	13	Diaphragm Stem	72694P001	
1	14	Secondary Diaphragm Plate	72689P001	Upper
1	15	Secondary Diaphragm	72688P001	
1	16	Secondary Diaphragm Plate	70012P049	Lower
1	17	Body Coupling	78134P002	
1	18	Valve Stem	72687P001	
1	19	Valve Cage	72691P004	
1	20	Balancing Piston	72695P001	
1	21	Felt Ring	72699P001	
1	22	Seat-Disc Retainer	72959P001	Lower
1	23	Seat-Disc Retainer	72960P001	Upper
1	24	Balancing Piston Ret. Cap	72966P001	
1	25	Vent Cap	78069P005	1" NPT
1	26	Spring Follower	73261P001	
1	27	Tag	78071P051	
1	28	Instruction Tag	73790P001	
1	29	Label	78482P002	

Optional Parts List

Quantity	Item#	Part Name	Part No.	Description
1	52	Pressure Spring	70157P025	1" – 3"
			70157P027	3" – 7"
			70157P006	7" – 14"
			70157P017	14" – 28"
			70157P024	#1 – #2
1	55	O-Ring (Valve Stem)	78037P054	Buna-N (Standard)
			78037P079	Viton
1	56	O-Ring (Valve Cage)	78037P040	Buna-N (Standard)
			78037P076	Viton
1	57	Valve-Seat Disc	72696P001	Buna-N (Standard)
			72696P002	Viton
1	58	O-Ring (Piston Cap)	78037P037	Buna-N (Standard)
			78037P085	Viton

Standard Spare Kits

Part Name	Part No.	Description
Spare Kit	73913K003	Includes Item # 3, 21, 55, 56, 57
Spare Kit	73913K004	Includes Item # 3, 8, 9, 10, 11, 12, 15, 21, 24, 25, 55, 56, 57

3" Model 3000 Industrial Regulator Assembly

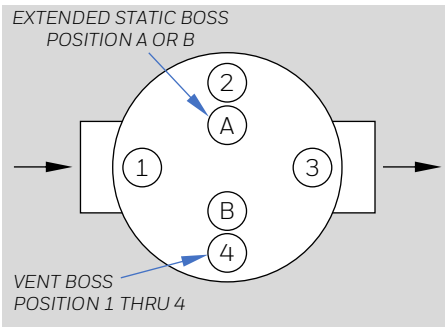

Note: Install balancing piston ring with black stripes up. Joint to be located on valve inlet side.

Regulator Assembly Positions

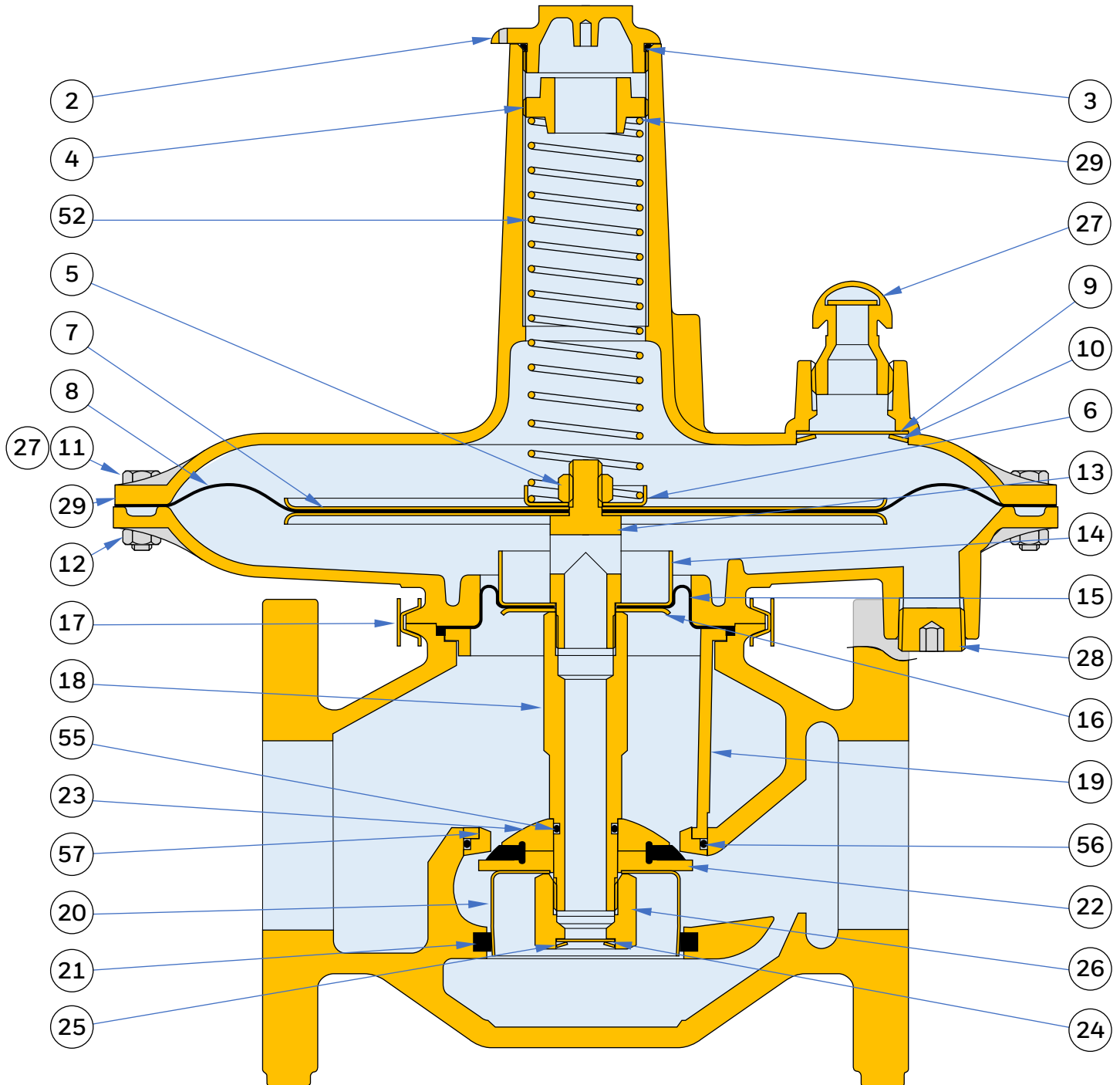

3" Model 3000 Industrial Regulator Assembly

Common Parts List

Quantity	Item#	Part Name	Part No.	Description
1	2	Seal Plug	70103P001	
1	3	O-Ring (Seal Plug)	42710P107	
1	4	Pressure-Adjusting Screw	73183P001	
1	5	Diaphragm Stem Nut	78020P008	
1	6	Spring Guide	70012P038	
2	7	Diaphragm Plate	70012P033	
1	8	Diaphragm	70014P179	
1	9	Vent Flapper	72770P002	
1	10	Retaining Ring (Vent Flapper)	92943P118	
12	11	Hex-Head Cap Screw	78001P032	
12	12	Hex Nut	78020P003	
1	13	Diaphragm Stem	72976P001	
1	14	Secondary Diaphragm Plate	72977P001	Upper
1	15	Secondary Diaphragm	72968P001	
1	16	Secondary Diaphragm Plate	70012P048	Lower
1	17	Body Coupling	78134P003	
1	18	Valve Stem	72973P001	
1	19	Valve Cage	72962P002	
1	20	Balancing Piston	72975P001	
1	21	Felt Ring	72699P002	
1	22	Seat-Disc Retainer	72974P001	Lower
1	23	Seat-Disc Retainer	72970P001	Upper
1	24	Valve-Stem Flapper	72163P012	
1	25	Ret. Ring (Valve Stem Flap)	78074P025	
1	26	Balancing Piston Ret. Nut	73287P001	
1	27	Vent Cap	78069P005	1" NPT
1	28	Pipe Plug (Lower Chamber)	78039P011	3/4" NPT
1	29	Spring Follower	73261P001	
1	30	Tag	78071P051	
1	31	Instruction Tag	73790P001	
1	32	Label	78482P002	

Optional Parts List

Quantity	Item#	Part Name	Part No.	Description
1	52	Pressure Spring	70157P028	1" – 3"
			70157P029	3" – 7"
			70157P030	7" – 14"
			70157P031	14" – 28"
			70157P032	#1 – #2
1	55	O-Ring (Valve Stem)	78037P044	Buna-N (Standard)
			78037P077	Viton
1	56	O-Ring (Valve Cage)	78037P045	Buna-N (Standard)
			78037P078	Viton
1	57	Valve-Seat Disc	72696P001	Buna-N (Standard)
			72696P002	Viton

Standard Spare Kits

Part Name	Part No.	Description
Spare Kit	73913K005	Includes Item # 3, 21, 24, 55, 56, 57
Spare Kit	73913K006	Includes Item # 3, 8, 9, 10, 11, 12, 15, 21, 24, 25, 55, 56, 57

3" Model 3010 Industrial Regulator Assembly

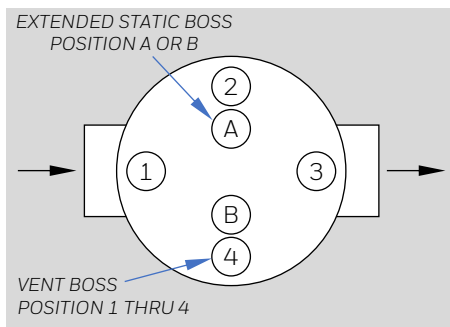

Note: Install balancing piston ring with black stripes up. Joint to be located on valve inlet side.

Regulator Assembly Positions

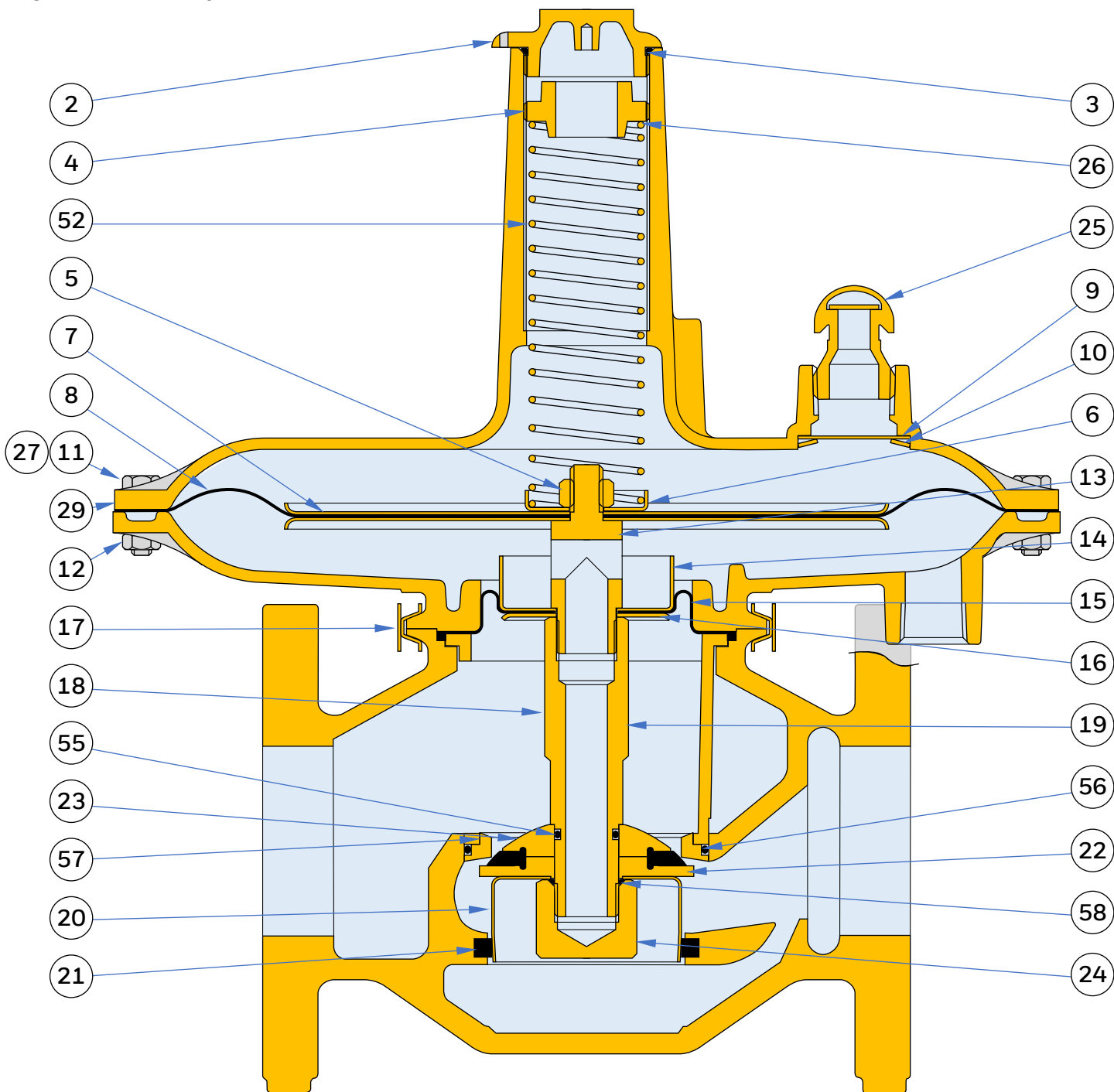

3" Model 3010 Industrial Regulator Assembly

Common Parts List

Quantity	Item#	Part Name	Part No.	Description
1	2	Seal Plug	70103P001	
1	3	O-Ring (Seal Plug)	42710P107	
1	4	Pressure-Adjusting Screw	73183P001	
1	5	Diaphragm Stem Nut	78020P008	
1	6	Spring Guide	70012P038	
2	7	Diaphragm Plate	70012P033	
1	8	Diaphragm	70014P179	
1	9	Vent Flapper	72770P002	
1	10	Retaining Ring (Vent Flapper)	92943P118	
12	11	Hex-Cap Screw	78001P032	
12	12	Hex Nut	78020P003	
1	13	Diaphragm Stem	72976P001	
1	14	Secondary Diaphragm Plate	72977P001	Upper
1	15	Secondary Diaphragm	72968P001	
1	16	Secondary Diaphragm Plate	70012P048	Lower
1	17	Body Coupling	78134P003	
1	18	Valve Stem	72973P001	
1	19	Valve Cage	72962P002	
1	20	Balancing Piston	72975P001	
1	21	Felt Ring	72699P002	
1	22	Seat-Disc Retainer	72974P001	Lower
1	23	Seat-Disc Retainer	72970P001	Upper
1	24	Balancing Piston Ret. Cap	73005P001	
1	25	Vent Cap	78069P005	1" NPT
1	26	Spring Follower	73261P001	
1	27	Tag	78071P051	
1	28	Instruction Tag	73790P001	
1	29	Label	78482P002	

Optional Parts List

Quantity	Item#	Part Name	Part No.	Description
1	52	Pressure Spring	70157P028	1" – 3"
			70157P029	3" – 7"
			70157P030	7" – 14"
			70157P031	14" – 28"
			70157P032	#1 – #2
1	55	O-Ring (Valve Stem)	78037P044	Buna-N (Standard)
			78037P077	Viton
1	56	O-Ring (Valve Cage)	78037P045	Buna-N (Standard)
			78037P078	Viton
1	57	Valve-Seat Disc	72696P001	Buna-N (Standard)
			72696P002	Viton
1	58	O-Ring (Piston Ret. Cap)	78037P056	Buna-N (Standard)
			78037P080	Viton

Standard Spare Kits

Part Name	Part No.	Description
Spare Kit	73913K005	Includes Item # 3, 21, 24, 55, 56, 57
Spare Kit	73913K006	Includes Item # 3, 8, 9, 10, 11, 12, 15, 21, 24, 25, 55, 56, 57

4" Model 3000 Industrial Regulator Assembly

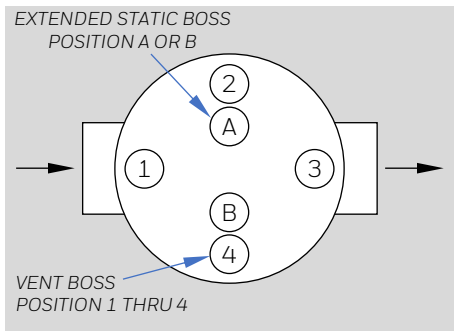

Note: Install balancing piston ring with black stripes up. Joint to be located on valve inlet side.

Regulator Assembly Positions

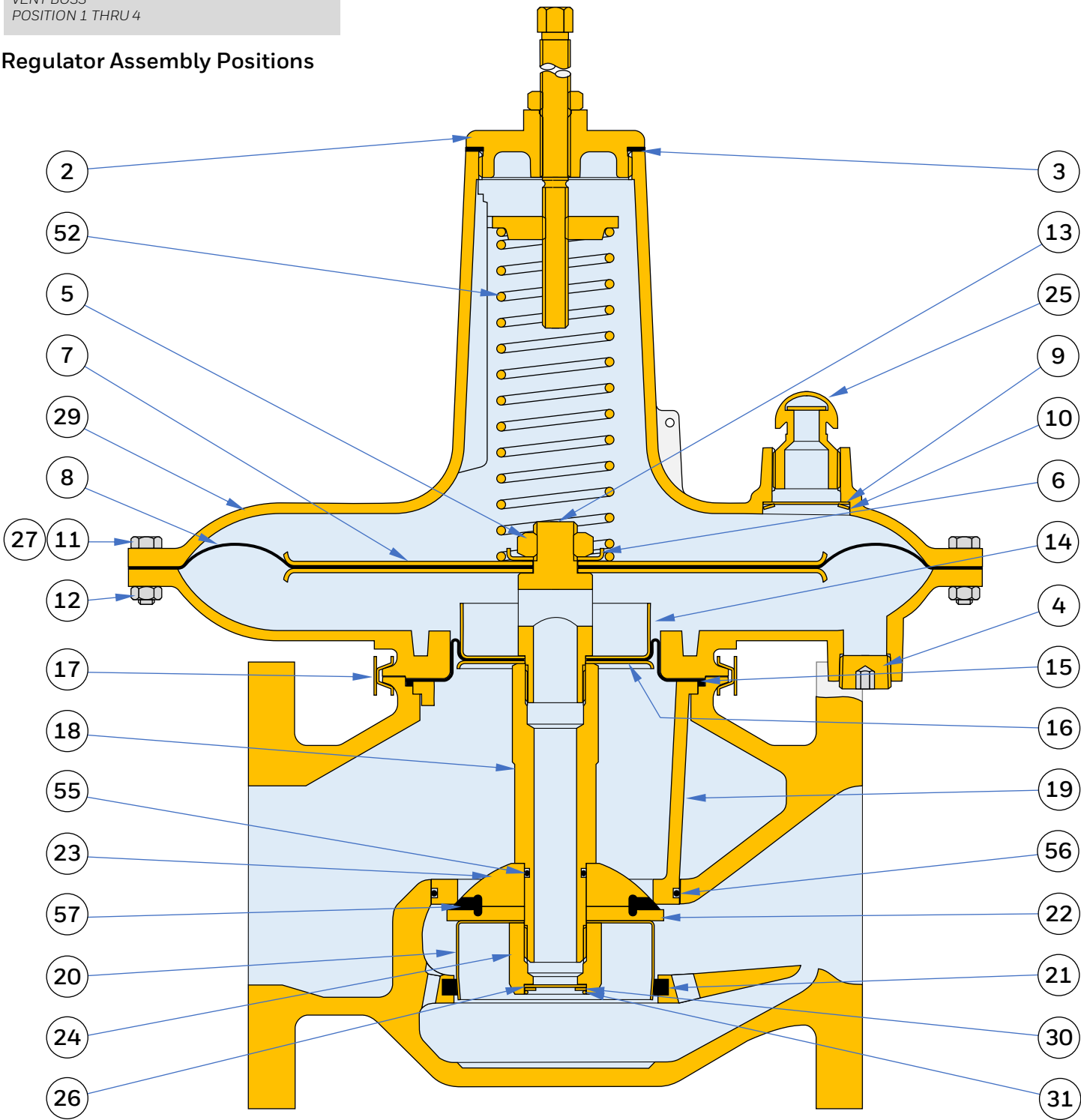

4" Model 3000 Industrial Regulator Assembly

Common Parts List

Quantity	Item#	Part Name	Part No.	Description
1	2	Seal-Plug Assembly	73486G001	
1	3	Seal-Plug Gasket	70019P087	
1	4	Pipe Plug (Lower Chamber)	78039P011	
1	5	Diaphragm Stem Nut	78022P008	
1	6	Spring Guide	70012P062	
2	7	Diaphragm Plate	70012P060	
1	8	Diaphragm	70014P180	
1	9	Vent Flapper	72770P002	
1	10	Retaining Ring (Vent Flapper)	92943P118	
16	11	Hex-Head Cap Screw	78001P032	
16	12	Hex Nut	78020P003	
1	13	Diaphragm Stem	73001P001	
1	14	Secondary Diaphragm Plate	72993P001	Upper
1	15	Secondary Diaphragm	72997P001	
1	16	Secondary Diaphragm Plate	70012P059	Lower
1	17	Body Coupling	78134P004	
1	18	Valve Stem	73000P001	
1	19	Valve-Cage Assembly	72998P001	
1	20	Balancing Piston	72994P001	
1	21	Felt Ring	72699P007	
1	22	Seat-Disc Retainer	72996P001	Lower
1	23	Seat-Disc Retainer	72995P001	Upper
1	24	Balancing Piston Ret. Nut	73289P001	
1	25	Vent Cap	78069P005	1" NPT
1	26	Stem-Flapper Stop	73329P001	
1	27	Tag	78071P051	
1	28	Instruction Tag	73790P001	
1	29	Label	78482P002	
1	30	Valve-Stem Flapper	72163P014	
1	31	Retaining Ring (Stem Flapper)	78074P009	

Optional Parts List

Quantity	Item#	Part Name	Part No.	Description
1	52	Pressure Spring	71411P036	4" – 8"
			71411P034	7" – 14"
			71411P037	14" – 28"
			71411P038	#1 – #2
1	55	O-Ring (Valve Stem)	78037P064	Buna-N (Standard)
			78037P083	Viton
1	56	O-Ring (Valve Cage)	78037P065	Buna-N (Standard)
			78037P084	Viton
1	57	Valve-Seat Disc	72999P001	Buna-N (Standard)
			72999P002	Viton

Standard Spare Kits

Part Name	Part No.	Description
Spare Kit	73913K007	Includes Item # 3, 21, 30, 55, 56, 57
Spare Kit	73913K008	Includes Item # 3, 8, 9, 10, 11, 12, 15, 21, 30, 31, 55, 56, 57

4" Model 3010 Industrial Regulator Assembly

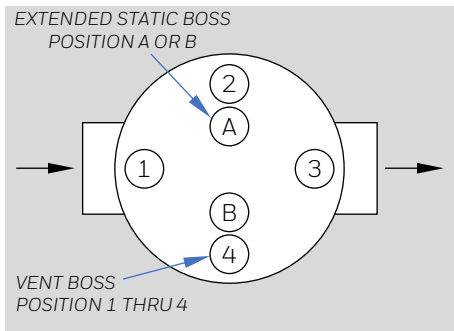

Note: Install balancing piston ring with black stripes up. Joint to be located on valve inlet side.

Regulator Assembly Positions

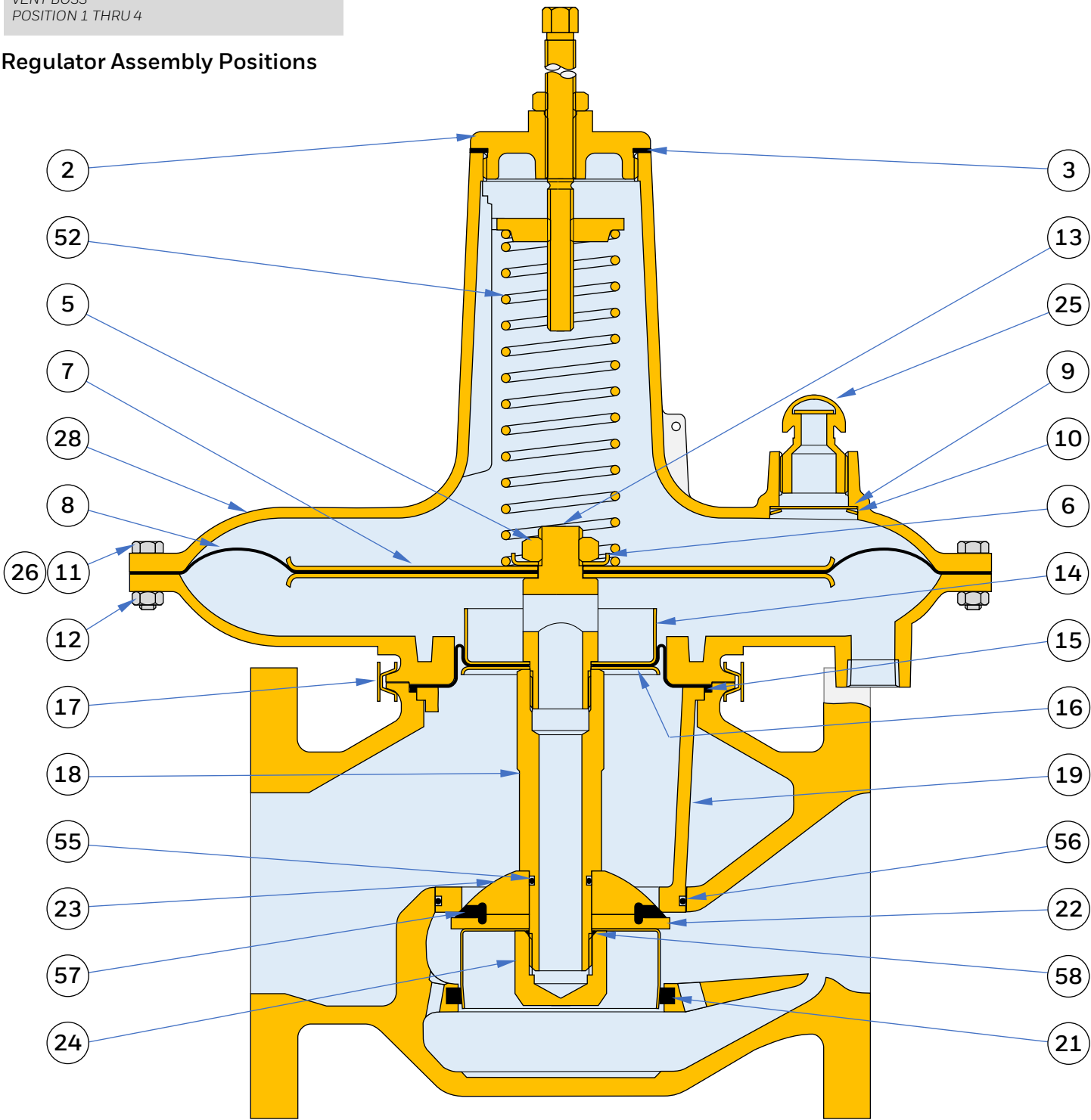

4" Model 3010 Industrial Regulator Assembly

Common Parts List

Quantity	Item#	Part Name	Part No.	Description
1	2	Seal-Plug Assembly	73486G001	
1	3	Seal-Plug Gasket	70019P087	
1	4	Caplug	78068P047	
1	5	Diaphragm Stem Nut	78022P008	
1	6	Spring Guide	70012P062	
2	7	Diaphragm Plate	70012P060	
1	8	Diaphragm	70014P180	
1	9	Vent Flapper	72770P002	
1	10	Retaining Ring (Vent Flapper)	92943P118	
16	11	Hex-Head Cap Screw	78001P032	
16	12	Hex Nut	78020P003	
1	13	Diaphragm Stem	73001P001	
1	14	Secondary Diaphragm Plate	72993P001	Upper
1	15	Secondary Diaphragm	72997P001	
1	16	Secondary Diaphragm Plate	70012P059	Lower
1	17	Body Coupling	78134P004	
1	18	Valve Stem	73000P001	
1	19	Valve-Cage Assembly	72998P001	
1	20	Balancing Piston	72994P001	
1	21	Felt Ring	72699P007	
1	22	Seat-Disc Retainer	72996P001	Lower
1	23	Seat-Disc Retainer	72995P001	Upper
1	24	Balancing Piston Ret. Cap	73290P001	
1	25	Vent Cap	78069P005	1" NPT
1	26	Tag	78071P051	
1	27	Instruction Tag	73790P001	
1	28	Label	78482P002	

Optional Parts List

Quantity	Item#	Part Name	Part No.	Description
1	52	Pressure Spring	71411P036	4" – 8"
			71411P034	7" – 14"
			71411P037	14" – 28"
			71411P038	#1 – #2
1	55	O-Ring (Valve Stem)	78037P064	Buna-N (Standard)
			78037P083	Viton
1	56	O-Ring (Valve Cage)	78037P065	Buna-N (Standard)
			78037P084	Viton
1	57	Valve-Seat Disc	72999P001	Buna-N (Standard)
			72999P002	Viton
1	58	O-Ring (Piston Cap)	78037P041	Buna-N (Standard)
			78037P088	Viton

Standard Spare Kits

Part Name	Part No.	Description
Spare Kit	73913K005	Includes Item # 3, 21, 24, 55, 56, 57
Spare Kit	73913K006	Includes Item # 3, 8, 9, 10, 11, 12, 15, 21, 24, 25, 55, 56, 57

Caution

“As a knowledgeable user of American Meter’s products, we are sure that you are aware that parts in the Company’s meters and regulators contain or are coated with heavy metals such as cadmium, zinc, lead and chromium. Obviously, therefore, repair or refurbishment of this equipment should take into account the presence of these materials and should comply with all state and federal requirements concerning worker protection, proper disposal and safety, including protection against exposure to dust and fumes.”

Honeywell American Meter Company has a program of continuous product development and improvement; and, therefore, the information in this bulletin is subject to change or modification without notice.

For more information

www.smartenergy.honeywell.com

Honeywell I Smart Energy

2221 Industrial Road
Nebraska City, NE 68410
T +1 402-873-8200
F +1 402-873-7616

American Meter Company is a registered trademark
of Honeywell International Inc.
3000MANUS I 01 I 06/23
© 2023 Honeywell International Inc.

Honeywell