

## CF4000 Series Continuous Flow Supplied Air (CF-SAR ) and Combination of Continuous Flow and Air Purifying (CF-SAR/APR) Respirator

### CF4000 Series: More choices on a Same Platform

The CF4000 Series offers two respirator options with the same proven RU6500 full tight facepiece. This feature provides protection from APR to CF-SAR with the same mask. It particularly benefits users who require respiratory protection across different respirator types.

Together with the Honeywell airline hoses and quick connecting couplers, the CF4000 Series offers a very reliable and economic system to provide respiratory protection against most gases, vapors and particulates for extended periods of time.

### Product Description

The CF4000 Series offers two options: the CF4001 Which is a CF-SAR only, and the CF4002, a combination CF-SAR/APR. These respirators are NIOSH approved with the Honeywell RU6500 Full Facepiece (sold separately).

### Protection Type

The CF4001 and CF4002 in the CF-SAR mode are approved by the National Institute of Occupational Safety and Health (NIOSH) to operate using a remote air source in environments that are not Immediately Dangerous to Life or Health (non-IDLH). They are Type C CF-SARs for protection from hazardous gases, vapors and/or particulates, where the concentration does not exceed 1000 times the Permissible Exposure Limit (PEL), is below the contaminant's IDLH, and there is sufficient oxygen according to the OSHA or CSA requirements.

When used in the APR mode, the CF4002 provides protection for entry, exit, to move from one air source to another where the concentration level does not exceed 50 times the PEL (if the worker has been quantitatively fit tested) or 10 times the PEL (if the worker has been qualitatively fit tested). Concentration has to be below the contaminant's IDLH and there must be sufficient oxygen according the OSHA and CSA requirements.

Note: PEL is defined as the maximum permissible 8-hour time weighted average (TWA) concentration established by applicable OSHA (Assigned Protection Factors outlined in 29 CFR 1910.134) or other government regulations, or by NIOSH, ACGIH or CSA.

### Certifications

The 7800 Series is tested and certified to NIOSH 42 CFR 84 standard as a Type C continuous flow supplied air respirator in non-IDLH environments.

### Assigned Protection Factors

- When in CF-SAR mode: APF of 1000
- When in APR mode, qualitatively fit tested: APF of 10
- When in APR mode, quantitatively fit tested: APF of 50



CF4001 – CF-SAR Configuration (left) & CF4002 – CF-SAR/APR Configuration

### Honeywell Safety Products

900 Douglas Pike  
Smithfield, RI 02917

US  
Tel: 800.430.4110  
Fax: 800.572.6346

Canada  
Tel: 888.212.7233  
Fax: 888.667.8477

Technical Services: 800.873.5242



# CF4000 Series Continuous Flow Supplied Air (CF-SAR ) and Combination of Continuous Flow and Air Purifying (CF-SAR/APR) Respirator

## Major Components

CF4001 CF-SAR assembly includes: breathing tube, belt, nozzle adapter and (2) cartridge connector caps.

CF4002 CF-SAR assembly includes: breathing tube, belt, nozzle adapter.

## CF4001 CF-SAR Configuration

The CF4001 configuration includes: a front port nozzle adapter with a cap; breathing tube; belt; and two (2) cartridge connector caps.

The front mount breathing tube connects to the RU6500 full facepiece front port by means of a nozzle adapter, while the side cartridge connectors are sealed with two (2) cartridge connector caps provided in the kit.

With the cartridge connectors capped with screw caps and the breathing tube connected, a continuous flow of air is supplied to the facepiece when the respirator is connected to an external air source.

## CF4002 CF-SAR Configuration

The CF4002 CF-SAR/APR configuration includes: a front port nozzle adapter with a cap; breathing tube; and belt.

The front mount breathing tube connects to the RU6500 full facepiece front port by means of a nozzle adapter. The two (2) cartridge connector screw caps are removed and the filter/cartridges are assembled in their place. With the breathing tube connected, a continuous flow of air is supplied to the facepiece when connected to an external air source.

When the breathing tube is disconnected from the air supply hose, a check valve in the breathing tube assembly prevents leakage of contaminated air through the facepiece breathing tube and the wearer's air is drawn through the cartridges and/or filters. This feature allows for safe entry, exit, movement from one air supply to another, or escape from an area in case of air supply failure.



CF4001 CF-SAR Configuration



CF4002 CF-SAR Configuration

## Breathing Airline Hose

The CF4000 Series is approved for use with 25', 50' and 100' AH9000 Series airline hoses (for both 1/2" and 3/8" I.D. hoses). The use of a hose with the 1/2" I.D. is preferable when the required air flow must be obtained at a lower pressure, such as when an ambient air pump is used. Hoses with 3/8" I.D. weigh less for a comparable length and may be the better choice when greater mobility is needed.

## Coupler Assemblies

Honeywell offers several brands (Cejn, Snap-Tite, Hansen, Foster and Schrader) of quick connect couplers so you can select one that is **incompatible with any couplers used at your site for non-breathing air and other gases**. A coupler assembly includes one male and one female to be used at the connection of hose to the air source. Individual male and female couplers are also available.

## Air Supply

The air supply may be a compressor and filter panel, or an ambient air pump, and must supply sufficient air flow to meet the minimum PSI noted on the respirator's pressure schedule. Air must be Grade D or better according to CGA G-7.1 "Commodity Specification for Air" in the USA or CSA Z180.1 in Canada.

# CF4000 Series Continuous Flow Supplied Air (CF-SAR ) and Combination of Continuous Flow and Air Purifying (CF-SAR/APR) Respirator

## Pressure Schedules for the CF4000 Series with AH9000 series hoses

HOSE LENGTH (feet)	AIR PRESSURE RANGE (psig)	
	For 99600 Series 3/8" I.D. Hose	For 99800 Series 1/2" I.D. Hose
25 – 75	17 - 37	15 - 35
100 – 200	20 - 43	16 - 37
225 – 300	27 - 50	17 - 39

### When using ambient air pumps

If an ambient air pump is used as the air source, the 25' length is not recommended as it will result in significantly warmer air delivered to the facepiece. Use of smaller I.D. hoses (3/8") will result in less air flow, and the minimum requirement of 4 CFM may not be delivered to the facepiece unless the pump is able to supply the required PSI of pressure.

### Material Composition

Part Number	Description	Material Composition
981206	Breathing tube assembly	Ethylene propylene
805007	Cartridge connector caps, two	Noryl 731 (Plastic)
50123586-001	CF-SAR nozzle adapter assembly	Noryl 731 (Plastic)
985231	Belt	Nylon

### Ordering Information CF4000 Series CF-SAR

Part Number	Description
CF4001	CF-SAR assembly includes breathing tube, belt, nozzle adapter and (2) cartridge connector caps.
CF4002	CF-SAR assembly includes breathing tube, belt, nozzle adapter.

### Ordering Information for Other System Components

Part Number	Description
<b>Quick-Connect Couplers</b>	
Add one of the following suffixes for the desired brand: Cejn: C, Foster: F, Hansen: H, Schrader: S, Snap-Tite: ST.	
88600	Assembly with one male and one female coupler, to connect breathing tube to 3/8" I.D. hose (includes 880161 & 880040)
88800	Assembly with one male and one female coupler, to connect breathing tube to 1/2" I.D. hose (includes 880161 & 880060)

### AH9000 Series of Airline Hoses

996025	25 ft Lightweight PVC textile reinforced airline 3/8" I.D. hose
996050	50 ft Lightweight PVC textile reinforced airline 3/8" I.D. hose
996100	100 ft Lightweight PVC textile reinforced airline 3/8" I.D. hose
998025	25 ft Lightweight PVC textile reinforced airline 1/2" I.D. hose
998050-H5	50 ft Lightweight PVC textile reinforced airline 1/2" I.D. hose
998100	100 ft Lightweight PVC textile reinforced airline 1/2" I.D. hose

### Facepieces

RU65001S	Silicone full facepiece, head strap, Small
RU65001M	Silicone full facepiece, head strap, Medium
RU65001L	Silicone full facepiece, head strap, Large

# CF4000 Series Continuous Flow Supplied Air (CF-SAR ) and Combination of Continuous Flow and Air Purifying (CF-SAR/APR) Respirator

## Cartridges & Filters

N75001L	Organic Vapor Cartridges
75SCL	Defender: Organic Vapors, Acid Gas (Chlorine, Hydrogen Chloride, Sulfur Dioxide, Hydrogen Sulfide, Hydrogen Fluoride, Chlorine Dioxide), Ammonia, Methylamine and Formaldehyde
7581P100L	Organic Vapor, P100 Cartridge/Filter Combination
75SCP100L	Defender: Organic Vapors, Acid Gas (Chlorine, Hydrogen Chloride, Sulfur Dioxide, Hydrogen Sulfide, Hydrogen Fluoride, Chlorine Dioxide), Ammonia, Methylamine, Formaldehyde and P100 Cartridge/Filter Combination.
7580P100	P100 Filter
N750029	Shower Cap, black. Protects P100 filters and cartridge filter combinations from water spray during abatement & decontamination; plus sparks and slag during welding and grinding operations.
7506N95	Filter Pad, N95 (10 per pack)
7506R95	Filter Pad, R95 (10 per pack)
7506N99	Filter Pad, R99 (10 per pack)
N750036	Assembly for filters. Includes (2) N750027 covers and (2) N750038 spiders to attach filter pads to Gas and Vapor Cartridges

## Replacement Parts and Composition

Diagram Number	Part Number	Description
1	981206	Breathing tube assembly
2	805007	Cartridge connector caps, two
3	50123586-001	CF-SAR nozzle adapter assembly
4	985231	Belt

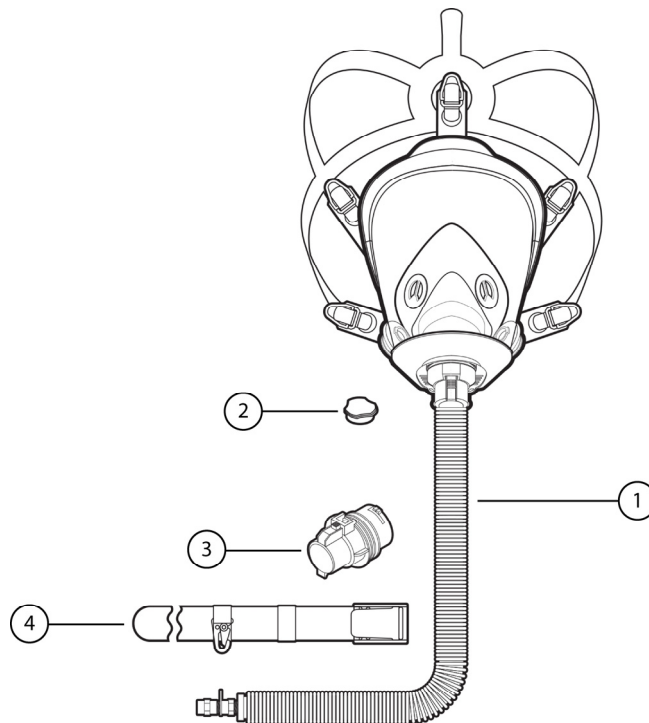

# CF4000 Series Continuous Flow Supplied Air (CF-SAR ) and Combination of Continuous Flow and Air Purifying (CF-SAR/APR) Respirator

## Accessories

Part Number	Description
962260	Spectacles kit
702019	Peel-away lens cover, tinted
702028	Peel-away lens cover, clear

## Product Weights & Dimensions

Part Number	Length Inches (cm)	Width Inches (cm)	Height Inches (cm)	Weight lb (kg)
<b>Assemblies</b>				
CF4001	9 (22.86)	13 (33.02)	5.5 (13.97)	2.00 (0.91)
CF4002	9 (22.86)	13 (33.02)	5.5 (13.97)	2.07 (0.94)

## Accessories

See RU6500 Tight Fitting Facepiece Tech Data Sheet

## Shipping Weights & Dimensions

Part Number	Length Inches (cm)	Width Inches (cm)	Height Inches (cm)	Weight lb (kg)
<b>Assemblies</b>				
CF4001	11 (27.94)	10 (25.40)	4.5 (11.43)	2.08 (0.94)
CF4002	11 (27.94)	10 (25.40)	4.5 (11.43)	2.18 (0.99)

## Country of Origin

Mexico

## Limited Warranty

Honeywell Safety Products warrants the CF4000 Series to the original owner to be free from defects in materials and workmanship for a period of one (1) year from the date of original shipment from Honeywell's factory. Honeywell's obligation under this limited warranty will be, at Honeywell's option, to repair or replace without charge the CF4000 Series or any of its components found by Honeywell to have been defective during the limited warranty period, under the following terms:

1. The warranty claim is made (i) by the owner who purchased the CF4000 Series new from Honeywell or an authorized Honeywell Distributor, and (ii) not more than three (3) months after the end of the limited warranty period.
2. The CF4000 Series or component is found by Honeywell to have been defective in normal use and service during the limited warranty period of one (1) year from the date of purchase by the original owner.
3. The CF4000 Series or component is returned freight prepaid to Honeywell, either to its factory or to a Honeywell authorized service center, and is thereafter returned to the owner freight collect.
4. This limited warranty does not apply to (i) any CF4000 Series or component found by Honeywell to have become defective as a result of any accident, alteration, misuse, abuse, or servicing with parts not approved by Honeywell; (ii) deterioration or aging of any component made of rubber or other elastomer since such components can be adversely affected by undue exposure to heat, sun, water, chemicals, ozone or other deteriorating elements; or (iii) ) facepiece lens, compressed-air cylinders and parts that become defective through normal use. The decision as to what constitutes normal use shall be made solely by HONEYWELL SAFETY PRODUCTS.
5. To maintain this limited warranty, the purchaser must perform maintenance and inspections as set forth in the Operating and Maintenance Instruction Manual for this product which shall include prompt replacement or repair of defective parts, and replacement of parts per the maintenance schedule as set forth in such Instructions.