

Installation Instructions for the Miniature SL1 Enclosed Switches

ISSUE 3
PK 88231

WIRING INSTRUCTIONS

1. To remove terminal cover, use a screw driver or similar tool to pull out either side of the mounting bracket.
2. Two rubber seals and one washer are included. Using the table below, determine the appropriate seal for the cable's diameter. The washer is not required with the large rubber seal. After assembly, tighten the cap nut using fingers only – never use tools to tighten the nut (see Figure 1).

Cable diameter	Rubber seal diameter
5.8 mm to 7.8 mm [0.23 in to 0.30 in]	Small (factory assembled)
7.9 mm to 9.6 mm [0.31 in to 0.38 in]	Large (supplied)

Figure 1 – Cable seal selection

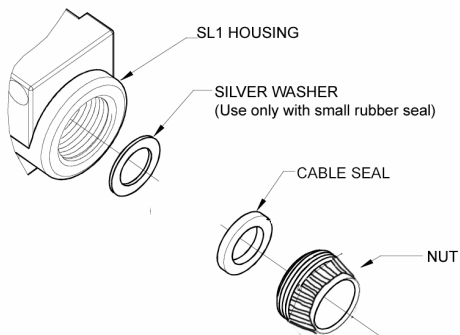

3. Wet cable surface with soap and water. Push cable through the seal and terminal cover.
4. Trim three lead wires and strip ends. (see Figure 2)

5 mm	0.2 in
10 mm	0.4 in
24 mm	0.95 in
37 mm	1.46 in

Figure 2 – Trim three leads

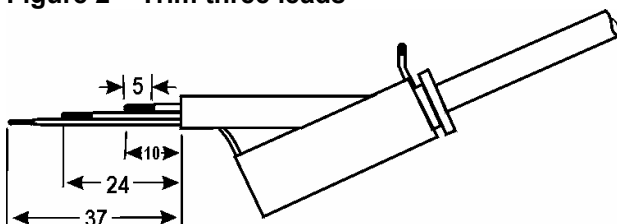

5. Use solderless terminals with insulating grips for M3 screws and wire as shown in Figure 3.

Figure 3 – Connecting leadwires

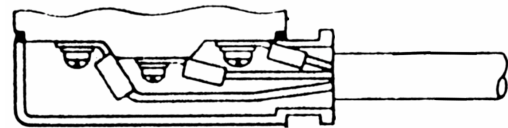

6. The roller lever type has reverse actuation and different contact arrangement. Connect wires as shown in Figure 4.

Figure 4 – Contact arrangement

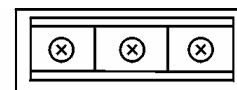

COM NO NC
Straight or Roller Plunger type

COM NC NO
Roller Lever type

7. The cable can exit at either side of the switch by changing the mounting direction of the terminal cover. Wire accordingly.
8. Snap-mount the terminal cover on the die-cast housing. Make sure the mounting bracket (see Figure 5, ①) catches the crimps (see Figure 5, ②) on the housing. Then, press cable seal into conduit.
9. To provide positive sealing, do not bend cable more than 30° at cable seal exit.

Figure 5 – Assemble switch

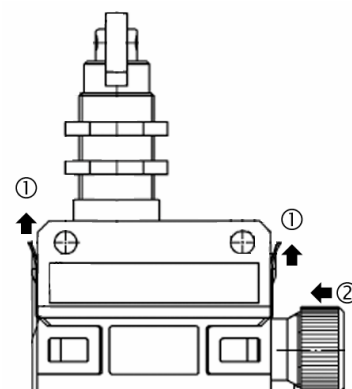

MOUNTING SWITCH

1. **Side Mounting** – Use two M4 screws. One hole is elongated for ease of mounting.
2. **Panel Mounting** – The bushings on the roller plunger and straight plunger types have M14 threads. Panel mount with the two nuts attached to the switch.
3. **Gang Mounting** – Two switches may be mounted side-by-side by using longer screws. Three or more may be mounted side-by-side with longer screws and the panel mounting nuts.

SETTING OVERTRAVEL

Each switch (except roller plunger with seal boot) has safe travel zone indication. As shown in Figure 6, roller plunger and straight plunger types should be set so that the top line of the plunger bushing is in the safe travel zone in order to get appropriate overtravel. For roller level types (Figure 7), the thickness of the lever should be in the safe travel zone to get the appropriate overtravel.

Figure 6 – Roller Plunger Safe Travel Zone

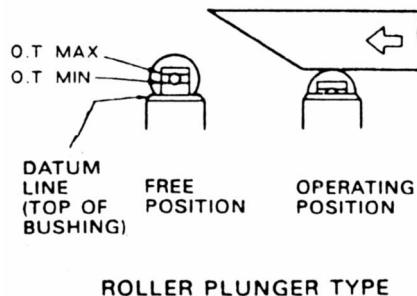
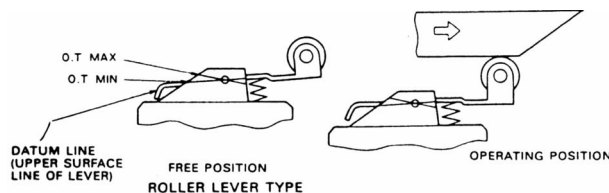

Figure 7 – Roller lever safe travel zone



WARRANTY/REMEDY

Honeywell warrants goods of its manufacture as being free of defective materials and faulty workmanship. Contact your local sales office for warranty information. If warranted goods are returned to Honeywell during the period of coverage, Honeywell will repair or replace without charge those items it finds defective. The foregoing is Buyer's sole remedy and is **in lieu of all other warranties, expressed or implied, including those of merchantability and fitness for a particular purpose.**

Specifications may change without notice. The information we supply is believed to be accurate and reliable as of this printing. However, we assume no responsibility for its use.

While we provide application assistance personally, through our literature and the Honeywell web site, it is up to the customer to determine the suitability of the product in the application.

For application assistance, current specifications, or name of the nearest Authorized Distributor, check the Honeywell web site or call:

1-800-537-6945 USA
 1-800-737-3360 Canada
 1-815-235-6847 International

FAX

1-815-235-6545 USA

INTERNET

www.honeywell.com/sensing
info.sc@honeywell.com

Honeywell

Control Products

Honeywell
 11 West Spring Street
 Freeport, Illinois 61032